

INSTRUCTIONS

1. Original and/or subsequent record used to evaluate the corner position.
2. Description of evidence found, note discrepancies in the record, state method of establishing lost or obliterated corners.
3. Description of monument and accessories set to perpetuate the corner position.
4. Sketch of corner, show all pertinent data which can best be shown in a sketch example, corner marking, topography ties, position of accessories, etc.
5. Certification must be signed and sealed by Land Surveyor registered in the State of Montana.
6. Fill in Cross Index & Section Diagram at bottom of sheet.

CERTIFIED CORNER RECORDATION

Corner NE SEC. COR. S26 T. 31 N. R. 34 W. P.M.M. Lincoln County

- I. 1903 Original Survey by Allen B. Benedict et. al: "Set a limestone, 21x12x3 ins., 16 ins. in the ground, for cor. of secs. 23, 24, 25 and 26 marked with 2 notches on S. and 1 notch on E. edges, from which

A fir, 8 ins. dia., bears N10° 30' E, 117 lks. dist., marked T31N R34W S24 BT.
A fir, 9 ins. dia., bears S65° 30' E, 107 lks. dist., marked T31N R34W S25 BT.
A fir, 10 ins. dia., bears S66° W, 45 lks. dist., marked T31N R34W S26 BT.
A pine, 8 ins. dia., bears N26° W, 39 lks. dist., marked T31N R34W S23 BT.

- II. Found a 2 ins. dia. iron pipe, 18 ins. above ground with 2 1/2 ins. dia. brass cap marked as shown:

NO RECORDATION ON FILE

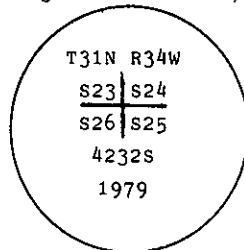

from which

A fir, 24 ins. dia., bears N10° E, 77.2 ft. (117 lks.) dist., overgrown scribe.
A fir, 23 ins. dia., bears S68° E, 69.2 ft. (105 lks.) dist., overgrown scribe.
A fir, 21 ins. dia., bears S66° W, 33.0 ft. (50 lks.) dist., visible scribe.
A pine, 16 ins. dia., bears N26° W, 29.0 ft. (44 lks.) dist., overgrown scribe.

Rock collar surrounding iron pipe.

- III. Painted red bands around the bearing trees and attached Land Survey Monument and Bearing Tree Signs.

Set a 6 ft. galvanized steel guard post with Land Survey Marker and Property Boundary decals, 3 ft. from corner.

Magnetic Declination 20° East

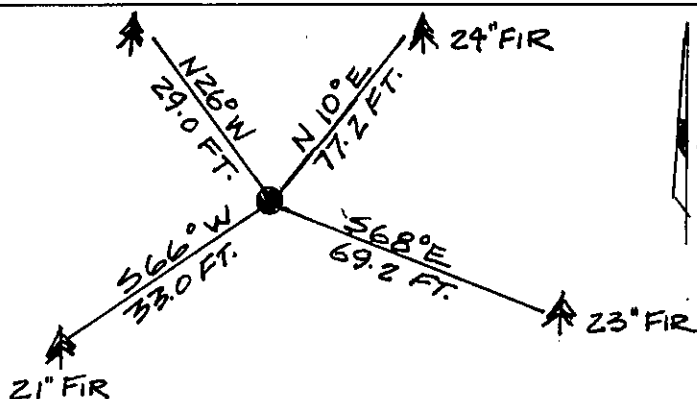

SKETCH OF CORNER

CERTIFICATION

Thomas M. Hommel

I, Thomas M. Hommel
certify the information shown herein is true and correct.

Signature Ground Party Chief

Alvah F. Hughes

I, Alvah F. Hughes
certify that this Corner Record correctly represents work performed by me or under my direction in compliance with the Montana Recordation Act" (70-22-101, et seq., M.C.A.)

Signature of Surveyor & Seal

Date: 1/10/92 Reg. No. 7322LS

Employer: U.S. FOREST SERVICE

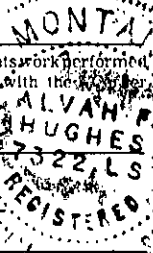

Office of Clerk and Recorder, County of Lincoln. This "corner record" was filed for record on 4-21-92 was noted on the cross-index plat and is assigned page No. 5043, in book No. Coral M. Cummings

County Official

R-214

31 N 34 W

Cross Index No. T. R. PMM

Sec. 26

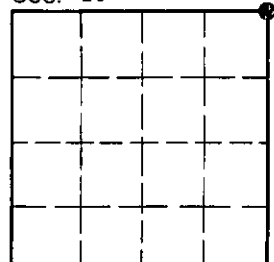

• - corner this sheet