

INSTRUCTIONS

1. Original and/or subsequent record used to evaluate the corner position.
2. Location of evidence found, note discrepancies in the record, state method of establishing lost or obliterated corners.
3. Description of monument and accessories set to perpetuate the corner position.
4. Sketch of corner, show all pertinent data which can best be shown in a sketch example, corner marking, topography ties, position of accessories, etc.
5. Certification must be signed and sealed by Registered Land Surveyor in State of Montana.
6. Fill in Cross Index & Section Diagram at bottom of sheet.

CERTIFIED CORNER RECORDATION

Cor or N 1/4 Corner Sec. 17 T. 31N R. 34W P.M.M. Lincoln County

1. 40.06 Chains: Set a limestone, 12 X 10 X 8 inches., 8 inches in the ground, for 1/4 Sec. Corner marked 1/4 on N. face; from which
 A willow, 6 inches diameter; bears N. 73°30'E., 26 links distance, marked 1/4 S 8 B.T.
 A willow, 6 inches diameter, bears S. 62°W., 14 links distance, marked 1/4 S 17 B.T.
2. After diligent search we found no evidence of original monument. Set corner by single proportionate distance.
3. Set: A 3" X 30" aluminum capped monument marked as shown below from which,
 A 14" Fir bears N 62°E 6.1 feet scribed S 1/4 S 8 B.T. and posted.
 A 14" Fir bears S 56°W 15.0 feet scribed N 1/4 S 17 B.T. and posted.
 A location poster on a 12" Fir bears N 20°W 5.4 feet.
 Painted monument and accessories with bright red paint.

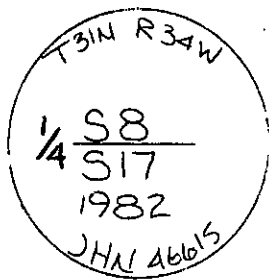

Set 3" aluminum monument marked as shown.

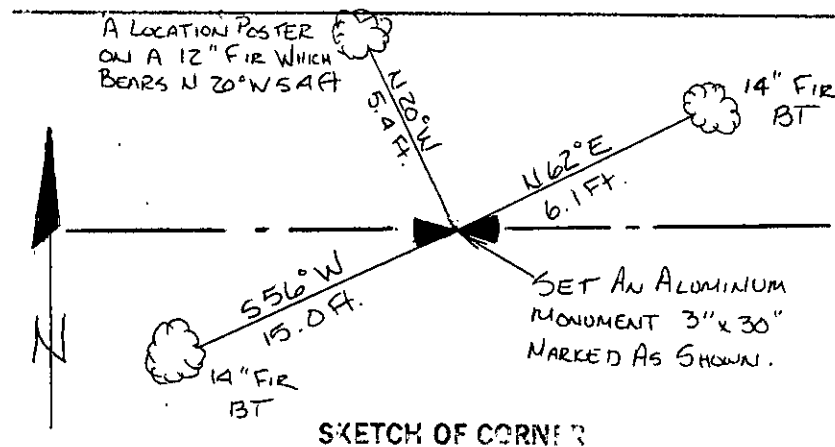

SKETCH OF CORNER

CERTIFICATION Jack H. Ninneman I, <u>Jack H. Ninneman</u> certify the information shown herein is true & correct. <u>Jack H. Ninneman</u> Signature Ground Party, Chief Jack H. Ninneman I, <u>Jack H. Ninneman</u> certify that this Corner Record correctly represents work done by me or under my direction in compliance with the Corner Recordation Act (22-10), et seq. M.D.A. <u>Jack H. Ninneman</u> Signature of Surveyor & Seal Date <u>Oct. 82</u> Reg. No. <u>4661S</u> Employer: <u>Ninneman Engineering Inc.</u>	
--	--

Office of Clerk and Recorder, County of LINCOLN. This "corner record" was filed for record on the Dec. 9 day of 1982 was noted on the cross-index plat and is assigned page No. 2097, in book No. Eleanor L. Vaughn by Betty L. Conner
 County Official deputy

Cross Index No. J-7

T. 31W R. 34W P.M.M.

* - corner this sheet