

INSTRUCTIONS

1. Original and/or subsequent record used to evaluate the corner position.
2. Description of evidence found, note discrepancies in the record, state method of establishing lost or obliterated corners.
3. Description of monument and accessories set to perpetuate the corner position.
4. Sketch of corner, show all pertinent data which can best be shown in a sketch example, corner marking, topography ties, position of accessories, etc.
5. Certification must be signed and sealed by Registered Land Surveyor in State of Montana.
6. Fill in Cross Index & Section Diagram at bottom of sheet.

CERTIFIED CORNER RECORDATION

Corner ¼ Corner Sec. 17 T. 31N R. 34W P.M.M. Lincoln County

1. 40.09 Chains: Set a Pine post, 3 feet long, 3 inches square, 24 inches in the ground, for ¼ Sec. corner, marked ¼S17 on N. face, and 20 on S. face; from which,
 - A Tamarack, 16 inches diameter, bears N. 19°E., 30 links distance, marked ¼S17B.T.
 - A Tamarack, 16 inches diameter, bears S. 21°W., 31 links distance, marked ¼S20B.T.
2. Found: No remains of original post.
 - Found 16" Larch bearing N 19°E 30 links (19.8 feet) scribed as per G.L.O. record. Tree down.
 - Found 16" Larch bearing S 21°W 31 links (20.5 feet) scribed as per G.L.O. record. Dead snag.
3. Set: A 3" X 30" aluminum capped monument marked as shown below from which,
 - An 8" Fir bears S 15°W 30.3 feet scribed ¼S20B.T. and posted.
 - A 10" Fir bears N 52°E 21.3 feet scribed ¼S17B.T. and posted.
 - A location poster on a 12" Pine bears S 55°E 13.6 feet.
 - Painted monument and accessories with bright red paint.

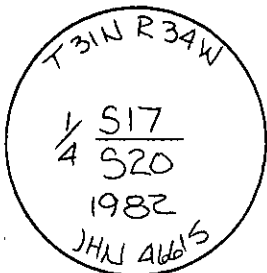

Set 3" aluminum monument marked as shown.

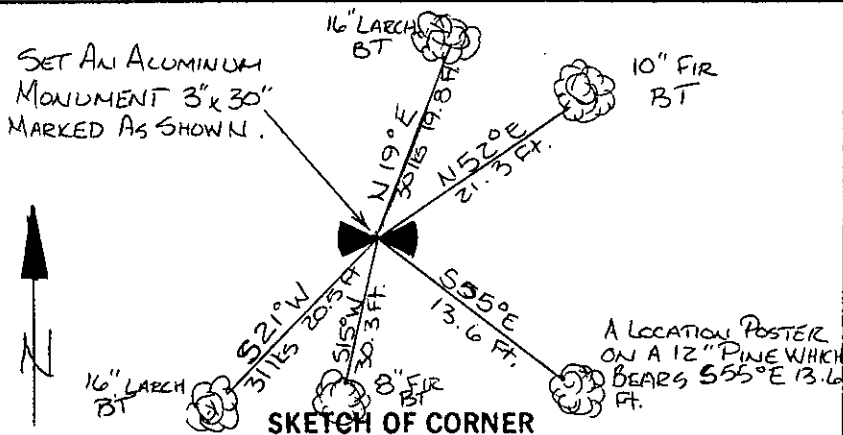

CERTIFICATION

I, Jack H. Ninneman
certify the information shown herein is true and correct.

Jack H. Ninneman
Signature Ground Party Chief

I, Jack H. Ninneman
certify that this Corner Record correctly represents work performed by me or under my direction in compliance with the "Corner Recordation Act" (70-22-101, et seq., M.D.A.)

Jack H. Ninneman
Signature of Surveyor & Seal

Date: Sept. 82 Reg. No. 4661S

Employer: Ninneman Engineering Inc.

Office of Clerk and Recorder, County of Lincoln. This "corner record" was filed for record on the Oct. 20 day of 19, 82 was noted on the cross-index plat and is assigned page No. 2001, in book No. _____

Eleanor L. Vaughn by Betty L. Conces
County Official *deputy*

Sec. 17

• corner this sheet