

INSTRUCTIONS

1. Original and/or subsequent record used to evaluate the corner position.
2. Description of evidence found, note discrepancies in the record, state method of establishing lost or obliterated corners.
3. Description of monument and accessories set to perpetuate the corner position.
4. Sketch of corner, show all pertinent data which can best be shown in a sketch example, corner marking, topography ties, position of accessories, etc.
5. Certification must be signed and sealed by Registered Land Surveyor in State of Montana.
6. Fill in Cross Index & Section Diagram at bottom of sheet.

CERTIFIED CORNER RECORDATION

Corner CW 1/16 Corner Sec. 14 T. 31N R. 34W P.M.M. Lincoln County

1. This corner not previously set.

2. Set: a 3" X 30" aluminum capped monument marked as shown below from which,
 A 12" Larch bears N 8°E 18.0 feet scribed CW 1/16 S14B.T. and posted.
 A 4" Fir bears S 28°E 6.0 feet scribed CW 1/16 S14B.T. and posted.
 A location poster on a 4" Fir bears N 56°W 6.6 feet.
 Painted monument and accessories with bright red paint.

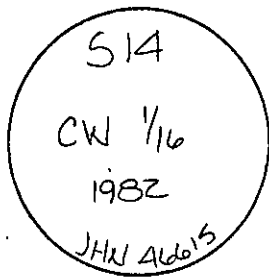

Set 3" aluminum monument marked as shown

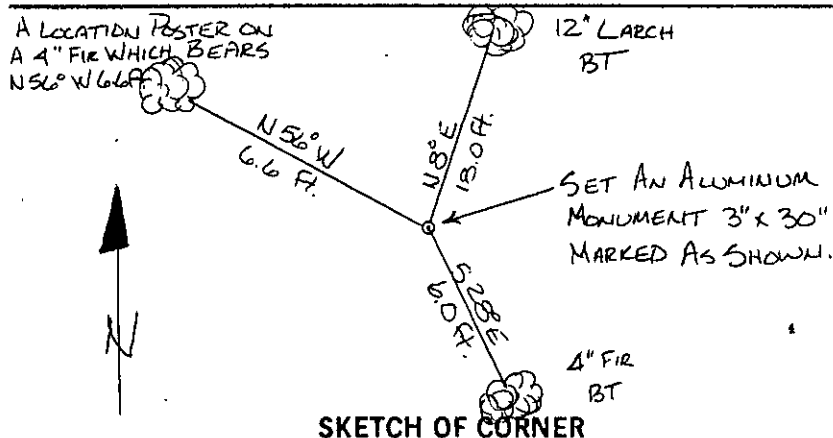

SKETCH OF CORNER

CERTIFICATION

Jack H. Ninneman

I, _____
 certify the information shown herein is true and correct.

Jack H. Ninneman
 Signature Ground Party Chief
 Jack H. Ninneman

I, _____
 certify that this Corner Record correctly represents work performed
 by me or under my direction in compliance with the "Corner
 Recordation Act" (70-22-101, et seq., M.D.A.)

Jack H. Ninneman
 Signature of Surveyor & Seal
 Oct. 82 46615

Date: _____ Reg. No. _____

Employer: Ninneman Engineering Inc.

Office of Clerk and Recorder, County of Lincoln. This "corner
 record" was filed for record on the Oct. 30 day of 19 82
 was noted on the cross-index plat and is assigned page No. 1983, in
 book No. _____
Eleanor L. Vaughn by Betty L. Conner
 County Official deputy

Sec. 14

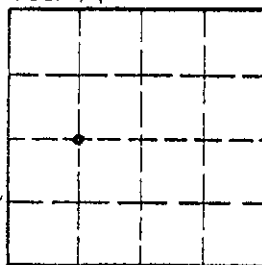

Cross Index No. L-18 T. 31N R. 34W P.M.M.

• corner this sheet