

# CERTIFIED CORNER RECORDATION

Corner East 1/4 Corner Section 24 T. 31N R. 34W P.M.M. Lincoln County

Found 3-1/4" Brass Cap per plat of Ridgeview Estates marked as shown

**Reference Points:**

- A) Found Bearing Tree sign (illegible) in a 9" Pine, N08°E 19.1'
- B) Found Bearing Tree sign marked S15°E 36.7" in an 18" Pine, N15°W 36.70'
- B) Set tack & 3/4" brass tag marked "A&C INC 17509" in a 16" Pine, S88°E 27.8'
- C) Set tack & 3/4" brass tag marked "A&C INC 17509" in a 16" Pine, N85°W 47.9'

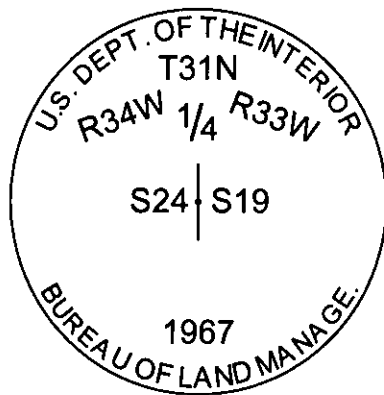

**SKETCH OF CORNER**

**CERTIFICATION**

I, Ken Lobstroh certify the information shown herein is true and correct.

*Ken Lobstroh*  
Signature Ground Party Chief

I, J. Ronald Dunsmore certify that this Corner Record correctly represents work performed by me or under my direction in compliance with the "Corner Recordation Act" (70-22-101, et seq., M.C.A.)

*J. Ronald Dunsmore*  
Signature of Surveyor & Seal

Date: 4/10/12 Reg. No. 17509 S

Employer: Adams & Clark, Inc.  
1720 W. Fourth Ave  
Spokane, WA 99201  
509-747-4600

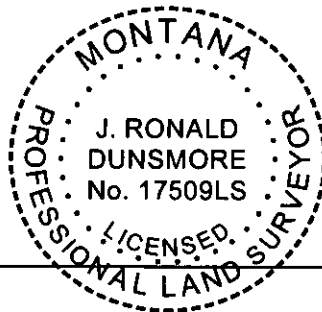

Office of Clerk and Recorder, County of Lincoln. This "corner record" was filed for record on 4-13-12

238164 BOOK: CCR CC&R'S PAGE: 11968 Pages: 1  
 STATE OF MONTANA LINCOLN COUNTY  
 RECORDED: 04/13/2012 11:25 KOI: CC&R'S  
 TAMMY D. LAUER CLERK AND RECORDER  
 FEE: \$0.00 BY: *Jearnie Dunsmore*  
 TO: FILED

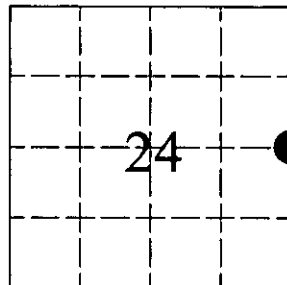

Cross Index No. P-25 T. 31N R. 34W PMM

● - Corner this sheet

Adopted July 1, 1981, Montana Board of Professional Engineers & Land Surveyors