

CERTIFIED CORNER RECORDATION

Corner C-E-SW-SW 1/256 Sec. 17 T. 31N R. 34W P.M., MT Lincoln County

- I. 1982 Certified Corner Recordation by Jack H. Ninneman, 4661S: This corner was not previously set. Set a 3" x 30" aluminum capped monument marked as shown below.

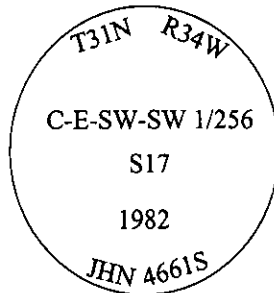

from which:

- A 10" Larch, bears N88°W, 20.7 feet, scribed "C-E-SW-SW 1/256 S17 BT" and posted.
- A 10" Larch, bears S33°W, 14.7 feet, scribed "C-E-SW-SW 1/256 S17 BT" and posted.
- A location poster on a 3" Fir, bears S60°E, 9.1 feet.

Painted monument and accessories with bright red paint.

- II. Found a 3 in. diam. aluminum capped monument, protruding 4 ins. above the ground, mkd. as shown, surrounded by a collar of stone and witnessed by the original bearing trees and location tree.

from which:

- A location poster on a 6 in. diam. fir, bearing S60°E, 9.1 ft. dist. of the monument.
- A larch, 12 ins. diam., bears S33°W, 14.7 ft. dist., with a healed face.
- A fallen larch, 11 ins. diam., bears N88°W, 20.7 ft. dist., with visible scribe.

- III. Established one new bearing tree:

- A larch, 10 ins. diam., bearing N58°E, 41.8 ft. dist., mkd. "C-E-SW-SW S17 BT".

Painted red bands around the bearing tree and attached Land Survey Monument and Bearing Tree signs.

Magnetic Declination: 20° East.

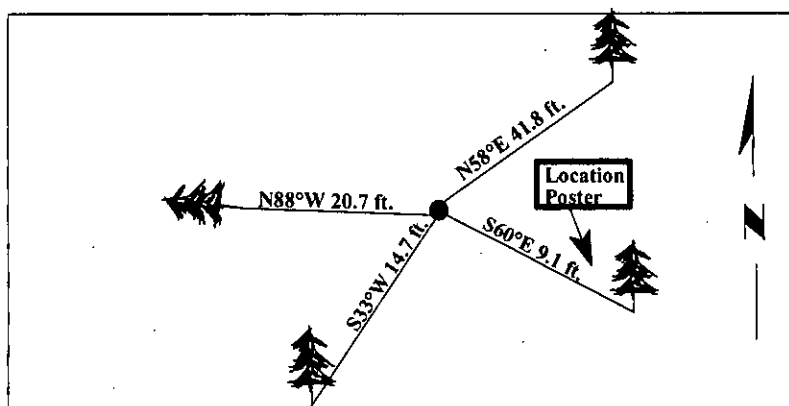

SKETCH OF CORNER

CERTIFICATION

I, Rex O. Rice
certify the information shown herein is true and correct.

Rice O. Rice

I, Steven A. Boyer
certify that this Corner Record correctly represents work performed by me or under my direction in compliance with the Corner Recordation Act (70-22-101, 1st sec., M.C.A.)

Steven A. Boyer
Signature of Surveyor & Seal

Date: 6/25/98

Reg. No.: 9750LS

Employer: U.S. FOREST SERVICE

LAND SURVEYOR

Office of Clerk and Recorder, County of Lincoln. This "corner record" was filed for record on Mar 3, 1999 was noted on the cross-index plat and is assigned page No. 10308 in book No. _____

Coral M. Cummins By Dep
County Official

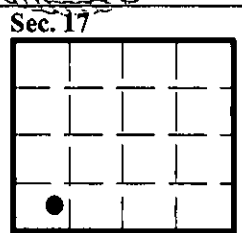

• - corner this sheet

Cross Index No. M.5-5.75 T. 31N R. 34W P.M., MT