

CERTIFIED CORNER RECORDATION

Corner C-W-W-SW 1/256 Sec. 17 T. 31N R. 34W P.M., MT Lincoln County

- I. 1982 Certified Corner Recordation by Jack H. Ninneman, 4661S: This corner was not previously set. Set a 3" x 30" aluminum capped monument marked as shown below.

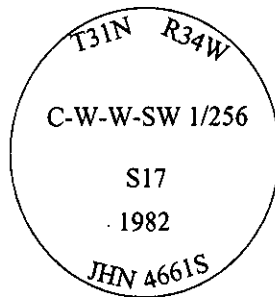

from which:

- A 7" Cedar, bears N18°W, 14.0 feet, scribed "C-W-W-SW 1/256 S17 BT" and posted.
- A 7" Cedar, bears S78°W, 15.5 feet, scribed "C-W-W-SW 1/256 S17 BT" and posted.
- A location poster on a 5" Cedar, bearing S72°W, 9.2 feet.

Painted monument and accessories with bright red paint.

- II. Found a 3 in. diam. aluminum capped monument, flush with the ground, mkd. as shown and witnessed by the original bearing trees and location tree.

from which:

- A location poster on a 7 in. diam. cedar, bearing S72°W, 9.2 ft. dist. of the monument.
- A tilted cedar, 8 ins. diam., bears S78°W, 15.5 ft. dist., with visible scribe.
- A cedar, 7 ins. diam., bears N18°W, 14.0 ft. dist., with visible scribe.

- III. Established one new bearing tree:

- A hemlock, 17 ins. diam., bearing N38°E, 12.4 ft. dist., mkd. "C-W-W-SW S17 BT".

Painted red bands around the bearing tree and attached Land Survey Monument and Bearing Tree signs.

Magnetic Declination: 20° East.

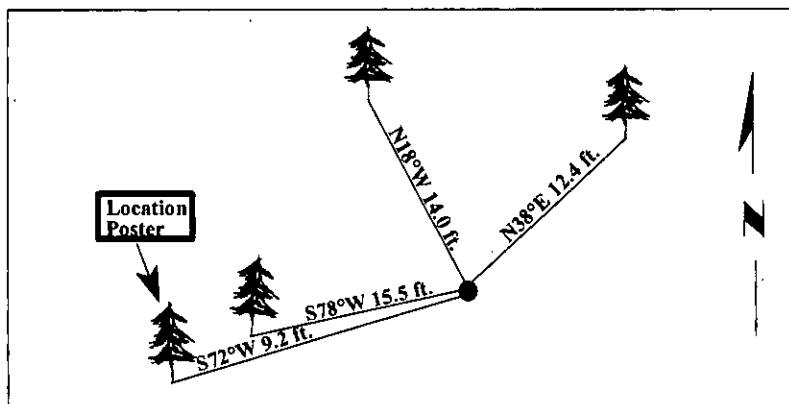

SKETCH OF CORNER

CERTIFICATION	
I. <u>Rex O. Rice</u>	certify the information shown herein is true and correct.
<u>Rex O. Rice</u>	
I. <u>Steven A. Boyer</u>	certify that this Corner Record correctly represents work performed by me or under my direction in compliance with the "Corner Recordation Act" (70-22-101, et seq., M.C.A.)
<u>Steven A. Boyer</u>	
Date: <u>6/24/98</u>	Signature of Surveyor & Seal <u>STEVEN A. BOYER</u>
Reg. No.: <u>9750LS</u>	9750LS
Employer: <u>U.S. FOREST SERVICE</u>	LAND SURVEYOR

Office of Clerk and Recorder, County of Lincoln. This "corner record" was filed for record on Mar 3, 1999 was noted on the cross-index plat and is assigned page No. 10306 in book No. _____

Coral M. Cumming By Dls
County Official

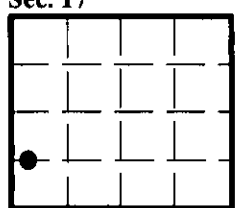

• - corner this sheet