

# CERTIFIED CORNER RECORDATION

Corner NE 1/16 Sec. 23 T. 31N R. 34W P.M., MT Lincoln County  
West W.C.

- I. No previous history.
- II. No evidence found.
- III. Set by survey, a 3/4 in. diam. aluminum driveable rod, 30 ins long, 29 ins. in the ground, with a 3 1/4 in. diam. aluminum cap, mkd. as shown.

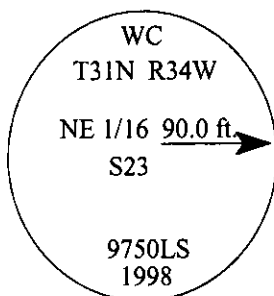

Established two bearing trees:

A larch, 30 ins. diam., bears S12°W, 18.0 ft. dist., mkd. "WC NE 1/16 S23 BT".  
A fir, 6 ins. diam., bears S49°W, 6.7 ft. dist., mkd. "X" on a snow blaze "BT".

Painted bearing trees and attached Land Survey Monument and Bearing Tree signs.

Magnetic Declination: 20° East

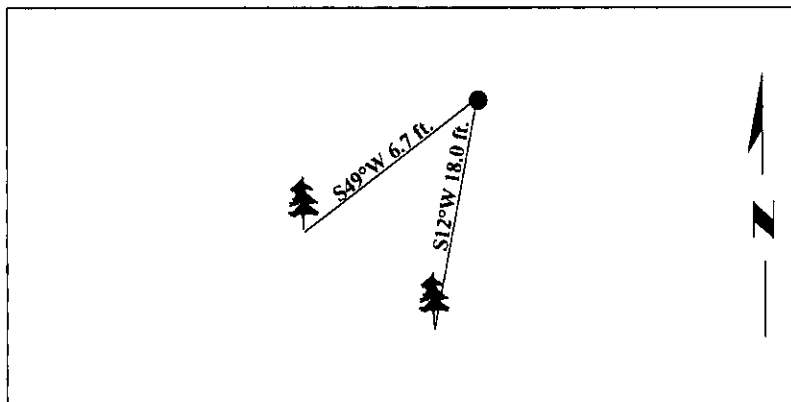

SKETCH OF CORNER

**CERTIFICATION**

I, Mark Federman  
certify the information shown herein is true and correct.

I, Steven A. Boyer  
certify that this Corner Record correctly represents work performed by me or under my direction in compliance with the "Corner Recordation Act" (10-20-107, et seq., M.C.A.)

Signature of Surveyor: [Signature]  
Reg. No.: 9750LS  
Employer: U.S. FOREST SERVICE

**MONTANA**  
**BOYER**  
**REGISTERED**  
**LAND SURVEYOR**

Office of Clerk and Recorder, County of Lincoln. This "corner record" was filed for record on 8-19-98 and was noted on the cross-index plat and is assigned page No. 10172 in book No. \_\_\_\_\_

Coral M. Cummings  
County Official

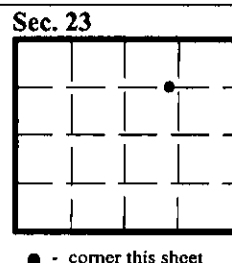

Cross Index No. West WC T. 31N R. 34W P.M., MT  
NE 1/16