

# CERTIFIED CORNER RECORDATION

Corner CSN 1/64 Sec. 23 T. 31N R. 34W P.M., MT Lincoln County

- I. No previous history.
- II. No evidence found.
- III. Set by survey, a 3/4 in. diam. aluminum driveable rod, 30 ins. long, flush with the ground, with a 3 1/4 in. diam. aluminum cap, mkd. as shown.

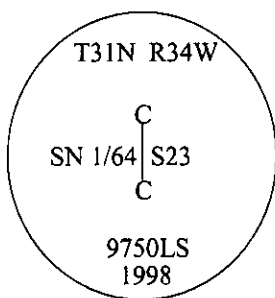

Established two bearing trees:

- A pine, 11 ins. diam., bears South, 6.8 ft. dist., mkd. "CSN 1/64 S23 BT".
- A larch, 9 ins. diam., bears S60°W, 31.0 ft. dist., mkd. "X" on a snow blaze "BT".

Painted bearing trees and attached Land Survey Monument and Bearing Tree signs.

Magnetic Declination: 20° East

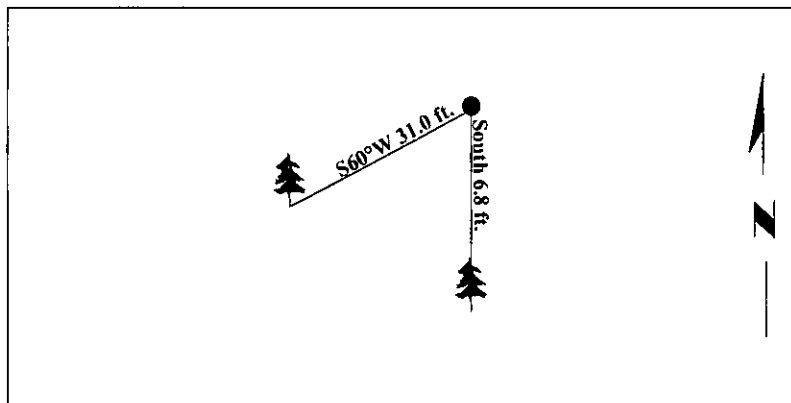

**SKETCH OF CORNER**

CERTIFICATION

I, Mark Federman  
certify the information shown herein is true and correct.

*Mark Federman*

---

I, Steven A. Boyer  
certify that this Corner Record correctly represents work performed by me or under my direction in compliance with the "Corner Recordation Act" (M.C.A. 82-7-211, 1, 2, 3, 4, 5, 6, 7, 8, 9, 10, 11, 12, 13, 14, 15, 16, 17, 18, 19, 20, 21, 22, 23, 24, 25, 26, 27, 28, 29, 30, 31, 32, 33, 34, 35, 36, 37, 38, 39, 40, 41, 42, 43, 44, 45, 46, 47, 48, 49, 50, 51, 52, 53, 54, 55, 56, 57, 58, 59, 60, 61, 62, 63, 64, 65, 66, 67, 68, 69, 70, 71, 72, 73, 74, 75, 76, 77, 78, 79, 80, 81, 82, 83, 84, 85, 86, 87, 88, 89, 90, 91, 92, 93, 94, 95, 96, 97, 98, 99, 100).

*Steven A. Boyer*  
Signature of Surveyor & Seal

Date: 7/21/98

Reg. No.: 9750LS

Employer: U.S. FOREST SERVICE

Office of Clerk and Recorder, County of Lincoln. This "corner record" was filed for record on 8-19-98 and was noted on the cross-index plat and is assigned page No. 10162 in book No. \_\_\_\_\_

*Coral M. Cummins*  
 County Official

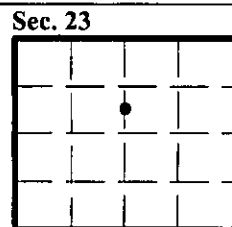

● - corner this sheet