

CERTIFIED CORNER RECORDATION

Corner Meander Corner S20 & S21 T. 31N R. 33W P.M.M. Lincoln County

1893 Original GLO record by Daniel P. Mumbrue, Book 2828 Page 28:

"Left bank of Kootenai river

Set a post 4 ft. long 4 ins. square 24 ins. in the ground for meander Cor. to Frac. Secs. 20 & 21 marked M.C. on N. face with T31N. on N. R.33W. S.21 on E. and S20 on W. faces, from which

A tamarack 20 ins. diam bears S60°E. 79 lks. dist. marked T31N.R.33W.S21 M.C.B.T.

A tamarack 24 ins. diam bears S56°10'W. 37 lks. dist. marked T31N.R.33W.S20 M.C.B.T."

1997 Remonumentation by Jane L. Eby, 8694ES:

Found a tamarack stump, 24 inches diameter, 36 inches tall. I cut into the healed over face and exposed scribing "BT" and an axe notch. I nailed the face with reverse scribing and notch back on the stump.

As determined from the original bearing tree stump, I set an aluminum pipe, 2 1/2 inches diameter, 30 inches long, with 3 1/4 inch diameter aluminum cap, marked as shown, in a mound of earth and stone, 4 feet diameter, 14 inches tall.

From which I establish 2 new bearing trees:

A Cedar, 5 inches diameter, bears S. 35° E., 31.5 feet distance, scribed "X" "BT".

A Cedar, 9 inches diameter, bears S. 43° W., 16.0 feet distance, scribed "T31N R33W S20 MC BT".

I painted blazes and faces red. I attached Land Survey Monument signs to new trees and tamarack stump.

Measurements were made with a steel tape and Silva hand compass using 19° East declination.

See Certificate of Survey No. 2561 for ties to adjacent controlling section corners.

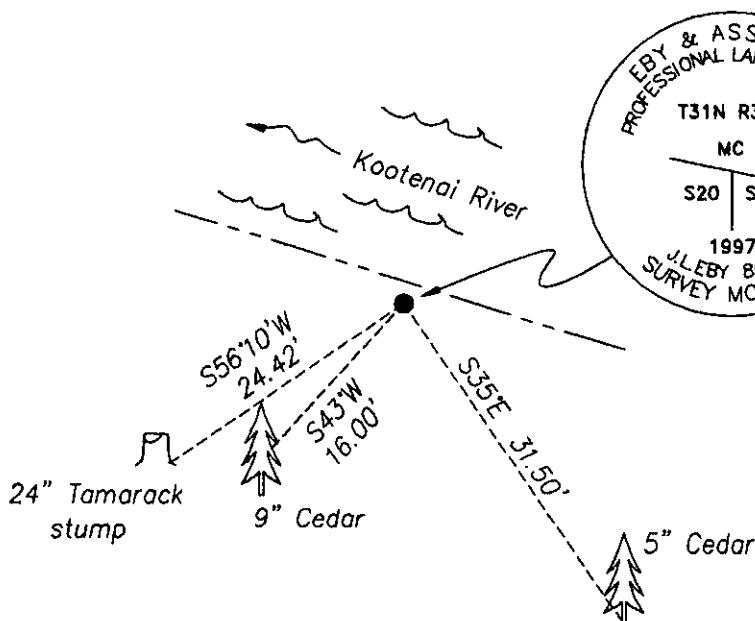

SKETCH OF CORNER

CERTIFICATION

1. Michael J. Drenth
certify the information shown herein is true and correct.
Michael J. Drenth
Signature of Ground Party Chief

2. Jane L. Eby
certify that this Corner Record correctly represents work performed by me or under my direction in compliance with the "Corner Recordation Act" (70-22-101, 102, 103, M.C.A.)
Jane L. Eby
Signature of Surveyor's Seal
Date: 5/30/97 Reg. No. 8694ES8694ES
Employer: Eby & Associates

Sec. 21

• corner this sheet

Office of Clerk and Recorder, County of Lincoln. This "corner

record" was filed for record on Aug 12, 1997

was noted on the cross-index plat and is assigned page No. 9902, in

book No. _____

Coral M. Cunningham By S.B.B.
County Official

Cross Index No. N/O-9 T. 31N R. 33W PMM

Adopted July 1, 1981, Montana Board of Professional Engineers & Land Surveyors