

## INSTRUCTIONS

1. Original and/or subsequent record used to evaluate the corner position.
2. Description of evidence found, note discrepancies in the record, state method of establishing lost or obliterated corners.
3. Description of monument and accessories set to perpetuate the corner position.
4. Sketch of corner, show all pertinent data which can best be shown in a sketch example, corner marking, topography ties, position of accessories, etc.
5. Certification must be signed and sealed by Land Surveyor registered in the State of Montana.
6. Fill in Cross Index & Section Diagram at bottom of sheet.

## CERTIFIED CORNER RECORDATION

Corner S.W. of Sec. 4 T. 31 N. R. 33 W. P.M.M. Lincoln County

- I. 1893 G.L.O. original record by D. P. MUMBRUE: Set a post 4 ft. long, 4 ins. square, 24 ins. in the ground, for Cor. to Secs. 4, 5, 8 & 9, marked:
- T31N S4 on N.E.  
R33W S9 on S.E.  
S 8 on S.W. AND  
S 5 on N.W. faces, with 5 notches on SOUTH, and 4 notches on EAST edges.

from which:

A pine, 12 ins. diam., bears N  $37\frac{1}{2}^{\circ}$  E, 22 lks., dist., mkd. T31N R33W S4 BT.  
A hemlock, 14 ins. diam., bears S  $50\frac{3}{4}^{\circ}$  E, 58 lks., dist., mkd. T31N R33W S9 BT.  
A hemlock, 12 ins. diam., bears S  $23\frac{1}{2}^{\circ}$  W, 51 lks., dist., mkd. T31N R33W S8 BT.  
A hemlock, 10 ins. diam., bears N  $24\frac{1}{2}^{\circ}$  W, 30 lks., dist., mkd. T31N R33W S5 BT.

- II. Found a  $\frac{3}{4}$  in. diam. iron pipe, 10 ins. above ground, loosely set. (No record.)

No bearing trees found.

- III. At the position determined by survey, set a 2  $\frac{1}{2}$  in. diam., 30 in. long aluminum pipe, 26 ins. in the ground, with a 3  $\frac{1}{4}$  in. U.S.D.A. Forest Service aluminum cap mkd. as shown:

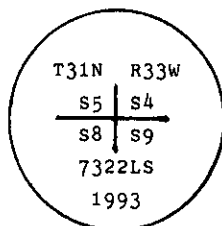

Established 4 new bearing trees:

A larch, 8 ins. diam., bears N  $12^{\circ}$  E, 29.4 ft., dist., mkd. T31N R33W S4 BT.  
A larch, 12 ins. diam., bears S  $63^{\circ}$  E, 13.9 ft., dist., mkd. T31N R33W S9 BT.  
A larch, 17 ins. diam., bears S  $74^{\circ}$  W, 54.3 ft., dist., mkd. T31N R33W S8 BT.  
A larch, 11 ins. diam., bears N  $2^{\circ}$  W, 42.3 ft., dist., mkd. T31N R33W S5 BT.

Painted a red band around bearing trees and attached Land Survey Monument and Bearing Tree signs.

Set a 6 ft. galvanized steel guard post with Land Survey Marker and Property Bounday decals, NORTH, 3 feet.

Magnetic Declination:  $20^{\circ}$  East.

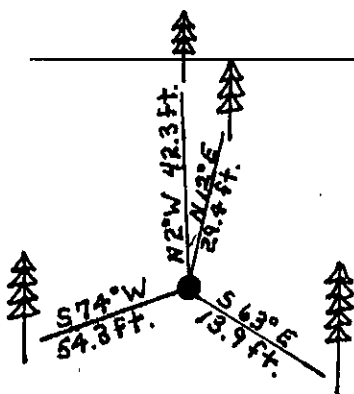

SKETCH OF CORNER

## CERTIFICATION

Thomas M. Hommel

I, Thomas M. Hommel

Signature Ground Party Chief

Alvah F. Hughes

I, Alvah F. Hughes

certify that this Corner Record correctly represents work performed by me or under my direction in compliance with the "Corner Recordation Act" (70-22-101, et seq., M.C.A.)

Date: 12/21/93 Reg. No. 7322LS

Employer: U.S. FOREST SERVICE

Office of Clerk and Recorder, County of Lincoln. This "corner record" was filed for record on Jan 12, 1994 was noted on the cross-index plat and is assigned page No. 6074, in book No. Correl M. Cummins By DB

County Official

Cross Index No. E-9 T. 31 N R. 33 W PMM

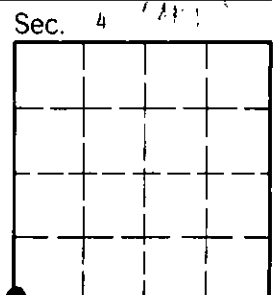

• - corner this sheet