

INSTRUCTIONS

1. Original and/or subsequent record used to evaluate the corner position.
2. Description of evidence found, note discrepancies in the record, state method of establishing lost or obliterated corners.
3. Description of monument and accessories set to perpetuate the corner position.
4. Sketch of corner, show all pertinent data which can best be shown in a sketch example, corner marking, topography ties, position of accessories, etc.
5. Certification must be signed and sealed by Land Surveyor registered in the State of Montana.
6. Fill in Cross Index & Section Diagram at bottom of sheet.

CERTIFIED CORNER RECORDATION

Corner S 1/4 of Sec. 5 T. 31 N. R. 33 W. P.M.M. Lincoln County

- I. 1893 G.L.O. original record by D. P. MUMBRUE: Set a post, and two bearing trees.

1967 B.L.M. remonumentation record by W. E. DAMM et al: The 1/4 sec. cor. of secs. 5 and 8, monumented with the remains of the original post, mkd. 1/4 S. on the N. face, and witnessed by the remains of the original bearing trees.

At the corner point, set an iron post, 30 ins. long, 2 1/2 ins. diam., 24 ins. in the ground, with brass cap mkd. as shown:

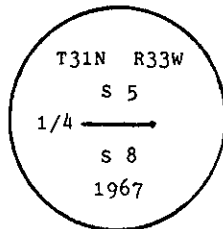

from which the original bearing trees:

- A fir, 12 ins. diam., bears S 19° E, 18 lks. dist., mkd. 1/4 S BT. (record: S24° E, 18 lks.)
A fir, 18 ins. diam., bears N 47 1/2° W, 21 lks. dist., mkd. 1/4 S. (record)

The new bearing tree:

- A fir, 9 ins. diam., bears S 15 1/2° E, 23 lks. dist., mkd. 1/4 S 8 BT.

Bury the remains of the original post alongside the iron pipe.

- II. Found a 2 1/2 in diam. iron pipe, 6 ins. above ground, firmly set, with a 3 1/2 in. B.L.M. brass cap mkd. as shown above, from which:

- A fir stump, 14 ins. diam., bears S24° E, 11.2 ft. (16.9 lks.) dist., no visible scribing
A fir, 15 ins. diam., bears S15° E, 15.2 ft. (23.0 lks.) dist., healed face.
A fir, 21 ins. diam., bears N 47° W, 13.9 ft. (21 lks.) dist., 1/4 S visible.

- III. Painted a red band around bearing trees and attached Land Survey Monument and Bearing Tree signs.

Set 6 ft. galvanized steel guard post with Land Survey Marker and Property Boundary decals, EAST, 3 ft.

Magnetic Declination: 20° East.

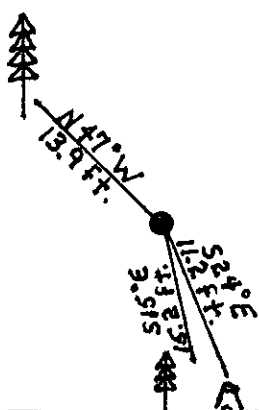

SKETCH OF CORNER



CERTIFICATION

Thomas M. Hommel

I, Thomas M. Hommel
certify the information shown herein is true and correct.

Signature Ground Party Chief

Alvah F. Hughes

I, Alvah F. Hughes
certify that this Corner Record correctly represents work performed by me or under my direction in compliance with the "Corner Recordation Act" (70-22-101, et seq., M.C.A.)

Signature of Surveyor & Seal

Date: 12/21/93 Reg. No. 7322LS

Employer: U.S. FOREST SERVICE

Office of Clerk and Recorder, County of Lincoln. This "corner record" was filed for record on Jan 12, 1994 was noted on the cross-index plat and is assigned page No. 6073, in book No. Coral M. Cumming County Official

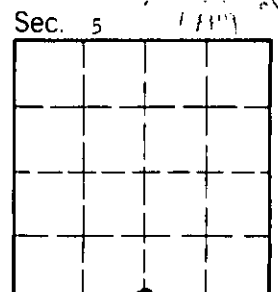

Cross Index No. E-7 T. 31 N R. 33 W PMM

• - corner this sheet