

INSTRUCTIONS

1. Original and/or subsequent record used to evaluate the corner position.
2. Description of evidence found, note discrepancies in the record, state method of establishing lost or obliterated corners.
3. Description of monument and accessories set to perpetuate the corner position.
4. Sketch of corner, show all pertinent data which can best be shown in a sketch example, corner marking, topography ties, position of accessories, etc.
5. Certification must be signed and sealed by Land Surveyor registered in the State of Montana.
6. Fill in Cross Index & Section Diagram at bottom of sheet.

CERTIFIED CORNER RECORDATION

Corner C-E-W-NW 1/256 S 4 T. 31 N. R. 33 W. P.M.M. Lincoln County

I. No previous record.

II. No previous record.

III. At the position determined by survey, set a 3/4 in. by 30 in. aluminum rod 26 ins. in the ground, with 3 1/4 in. aluminum U.S.D.A. Forest Service cap, marked as shown:

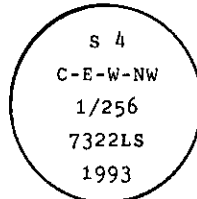

Established two bearing trees:

A fir, 4 ins. diam., bears S40°E, 13.2 ft. dist., scribed X BT.

A pine, 7 ins. diam., bears S5°E, 27.8 ft. dist., scribed C E W NW 1/256 S4 BT.

Painted a red band around bearing trees and attached Land Survey Monument and Bearing Tree signs.

Set a 6 ft. galvanized steel guard post with Land Survey Marker and Property Boundary decals, SOUTH, 3 ft.

Magnetic Declination 20° East

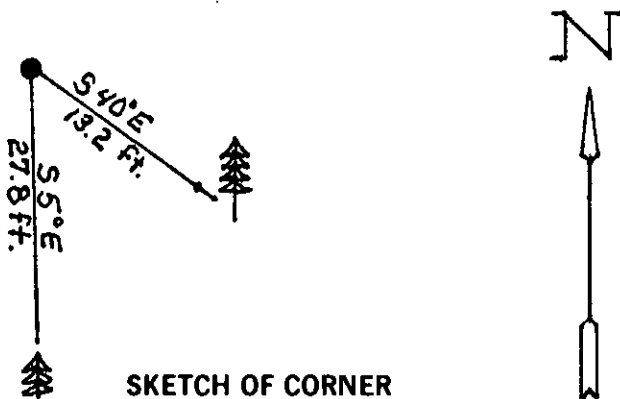

SKETCH OF CORNER

CERTIFICATION

Rex O. Rice

I, Rex O. Rice certify the information shown herein is true and correct.

Signature Ground Party Chief

Alvah F. Hughes

I, Alvah F. Hughes certify that this Corner Record correctly represents work performed by me or under my direction in compliance with the "Corner Recordation Act" (70-22-101, et seq., M.C.A.)

Signature of Surveyor

Date: 12/21/93 Reg. No. 7322LS

Employer: U.S. FOREST SERVICE

Office of Clerk and Recorder, County of Lincoln. This "corner record" was filed for record on Jan, 12, 1994 was noted on the cross-index plat and is assigned page No. 6068, in book No. Coral M. Cummings By SB County Official

Sec. 4

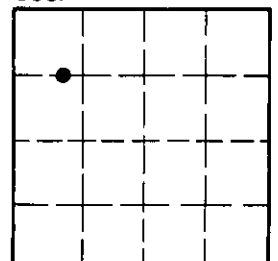

• - corner this sheet

Cross Index No. B-9.75 T. 31 N R. 33 W PMM