

INSTRUCTIONS

1. Original and/or subsequent record used to evaluate the corner position.
2. Description of evidence found, note discrepancies in the record, state method of establishing lost or obliterated corners.
3. Description of monument and accessories set to perpetuate the corner position.
4. Sketch of corner, show all pertinent data which can best be shown in a sketch example, corner marking, topography ties, position of accessories, etc.
5. Certification must be signed and sealed by Land Surveyor registered in the State of Montana.
6. Fill in Cross Index & Section Diagram at bottom of sheet.

CERTIFIED CORNER RECORDATION

Corner M.C.S19&S24 COR 1 H.E.S.444 T. 31 N., R. 32 W., P.M.M. Lincoln County

I. 1893 GLO Record: Set a post 4 ft. long 4 ins. square 24 ins. in the ground for M.C. to frac.sec. 19 & 24 marked M.C. on N. face with T31N on south; R31W S19 on East and R32W S24 on west faces from which;

A cedar 10 ins. diam. bears S47° 1/4' E 37 lks. dist. marked T31N R31W S19 MC BT.
 A fir 28 ins. diam. bears S12° W 9 lks. dist. marked T31N R32W S24 MC BT.
 The original call from the section corner north was 11.09 chs.

1915 H.E.S. 444 Cor.1: Established meander corner. Set a quartsite stone 24X8X8 ins. 14 ins. in the ground marked MC. on N. face 6 notches on E. face and a cross (x) on top for the exact corner point, from which;

A cross (x) on a cedar tree, 6 ins. diam., bears S85° 20' E 55 lks. dist. blazed and scribed T31N R31W S19 MC BT.
 A cross (x) on a cedar tree 6 ins. diam. bears S60° 50' W 46 lks. dist. blazed and scribed T31N R32W S24 MC BT.
 The original north south section line was retraced and the retracement call was 10.98 chs. (Thus the original post was lost due to erosion of river bank.)

1963 C.of S.#1401: by J.Ninneman 534ES, Called for M.C. post.

1975 C.of S.#126: by M.Lauteren 4232S, Called for 3"X3" wooden post.

II. Found Stone 9"X9" buried 12 ins. underground, marked X on top, MC on north face, R31W S19 on east face, R32W S24 on west face and T31N on south face. from which;

Chopped stump 9 ins. diam. bears S85° E 36 ft. dist. no scribe.
 Cedar 19 ins. diam. bears S60° W 30.4 ft. dist. no scribe.
 No other remains of original BT's found.

III. Set a guard post, with a "Survey Marker" decal attached, 2 ft. N. from corner. From which I scribed and marked one new bearing tree.

Cedar 5 ins. diam. bears S80° E 7.3 ft. dist. mrkd. X BT.
 Painted a red band around each bearing tree and attached "Attention" and "Bearing Tree" signs where needed.

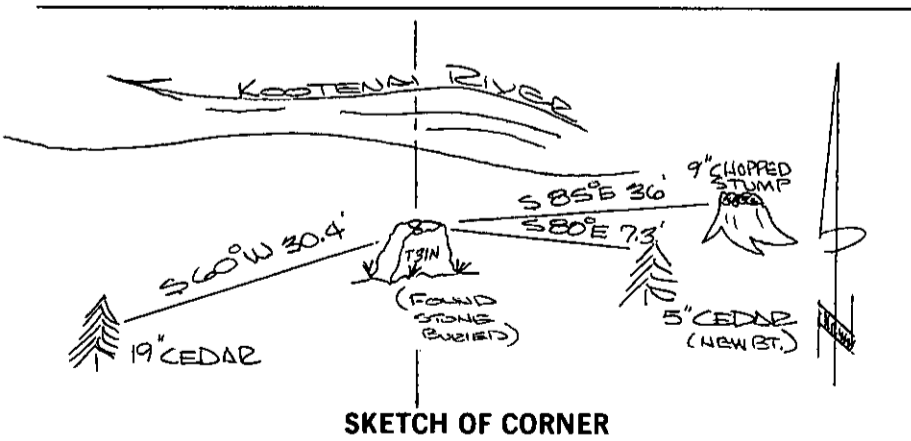

CERTIFICATION

Gary C. Crison

I, _____ certify the information shown herein is true and correct.

Signature of Second Party: _____
 Thomas C. Crison

I, _____ certify that this Corner Record Correctly represents work performed by me or under my direction in compliance with the "Corner Recordation Act" of 1971, Chapter 10, C.M.S. 1971, 10-1-101 through 10-1-104.

Signature of Registered Land Surveyor: _____
 Gary C. Crison

Date: 11/87 Reg. No. 5612

Employer: U.S. FOREST SERVICE

Office of Clerk and Recorder, County of Lincoln. This "corner record" was filed for record on Dec 10, 1987 was noted on the cross-index plat and is assigned page No. 3780, in book No. _____

Janet B. Sugilby Deputy
 County Official

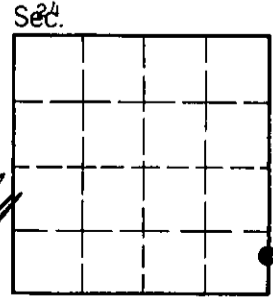

Cross Index No. Q-R 25 T31 N R32 W PMM

INSTRUCTIONS TO SURVEYORS FOR COMPLETION OF CERTIFIED CORNER RECORDATION FORMS

I. ORIGINAL AND/OR SUBSEQUENT RECORD:

This item should describe or quote those portions of the original or subsequent record which were used in evaluating the corner position. The original record will usually be the General Land Office field notes. Subsequent record can come from several sources: Previously filed corner records, maps and plats, private and public records, etc. Some of the subsequent record, even though not in the public record, but known to have validity by the surveyor, may be quoted and appropriately noted.

The record data helps support the reestablished corner position because it clearly shows what history the surveyor based his corner position on. In some cases, however, the record may be unknown or not pertinent. A statement to that effect should appear on the corner record.

II. DESCRIPTION OF EVIDENCE FOUND OR METHOD OF LOCATING CORNER POSITION:

This item will describe the original or subsequent record evidence found. If portions of the found evidence cannot be reconciled with the record, then the disregarded record should be noted, and, if possible, an opinion as to its cause narrated.

If no physical evidence of the original or subsequent monuments and accessories can be found, then the method used to reestablish the lost or obliterated corner (single proportion, fence intersection, parol evidence, terrain calls, centerline of road, etc.) shall be indicated.

III. DESCRIPTION OF MONUMENTS AND ACCESSORIES SET TO PERPETUATE THE CORNER POSITION:

This item should list all details about the corner and its location which will help exclusively identify the corner position; including size and type of monument, how marked if not shown in sketch, and distinguishing topographic calls which help locate the corner. In many cases, instructions on how to find the corner should be included.

References or ties to other corners are optional and may be drawn on the face or back of the corner record form, or references to Certificate of Survey may be made. Separate drawings may be attached to the corner form.

If state plane coordinate values for the corner position are shown, then the control upon which they are based should be indicated.

IV. SKETCH OF CORNER:

This item will usually show how a found or set corner is marked and may also show topography or accessory monuments found or set and their relation to the corner. There is no stipulated format; the sketch could be transcribed field note entries.

V. CERTIFICATION:

The name and signature of the ground party chief is optional.

The Surveyor who performed or directed the field work which is depicted on the "Certified Corner Record" shall sign and affix his seal in the Certification.

The employer blank is optional but useful in tracking down original field note data or adjacent record if, in the future, questions arise about the corner.

VI.

The Cross Index at the bottom of the page should be completed by the Surveyor. Only the single Township Index where the corner is filed shall be completed.

The lower righthand corner is a corner location diagram and should have the pertinent section filled in at the top and a closed circle indicating the appropriate corner position in the section filled in. This is intended to be an aid in searching the "Record" once it has been filed.

