

INSTRUCTIONS

1. Original and/or subsequent record used to evaluate the corner position.
2. Description of evidence found, note discrepancies in the record, state method of establishing lost or obliterated corners.
3. Description of monument and accessories set to perpetuate the corner position.
4. Sketch or corner, show all pertinent data which can best be shown in a sketch example, corner marking, topography ties, position of accessories, etc.
5. Certification must be signed and sealed by Registered Land Surveyor in State of Montana.
6. Fill in Cross Index & Section Diagram at bottom of sheet.

CERTIFIED CORNER RECORDATION

Corner 7 Sec. 28 T. 31N R. 33W P.M.M. Lincoln County

1. This corner not previously set.

2. None

3. Set a 5/8" X 24" rebar, capped with J.H.N. 4661S stamped on cap from which?
A 6" P.Pine bears S 51°W 43.2 ft. scribed E 1/16 S28 BT.

A location poster and attention signs on a 22" P.Pine bears S25°W 58.1 ft.

An 8" D. Fir bears S60°E 46.5 ft. scribed E 1/16 S28 BT.

Posted bearing trees with bearing tree signs.

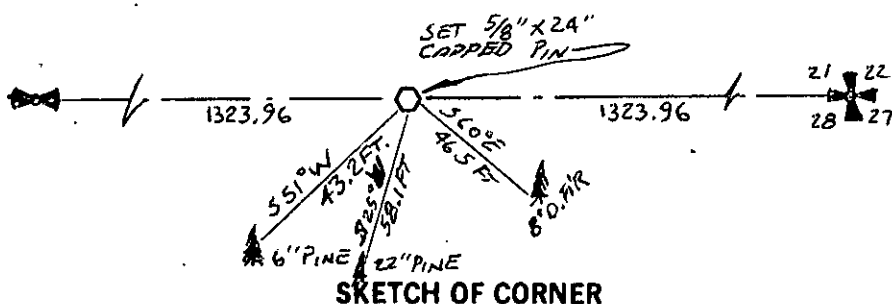

SKETCH OF CORNER

CERTIFICATION

I, David Stanley

certify the information shown herein is true and correct.

David Stanley
Signature Ground Party Chief

I, Jack H. Ninneman

certify that this Corner Record correctly represents work performed by me or under my direction in compliance with the "Corner Recordation Act" (70-22-101, et seq., M.D.A.)

Jack H. Ninneman
Signature of Surveyor & Seal

Date: 4/16/84 Reg. No. 4661S
Employer: Ninneman Engineering Inc.

Office of Clerk and Recorder, County of Lincoln. This "corner record" was filed for record on the April 23 day of 1984 was noted on the cross-index plat and is assigned page No. 2608, in book No. _____

Janet BF Siegel by Betty L. Conner
County Official deputy

Cross Index No. _____ T. 31N R. 33W P.M.M.

Sec. 28

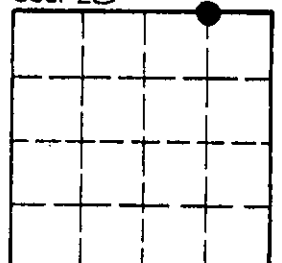

• - corner this sheet