

CERTIFIED LAND CORNER RECORDATION

NORTH 1/16 CORNER ON WEST LINE OF SEC. 16 TWP. 31 N., R. 33 W. M. P. M.

DESCRIPTION OF CORNER EVIDENCE FOUND, AND ORIGINAL RECORD (IF KNOWN)

North 1/16 Corner on West line was not set at time of original survey.
N 1/4 Corner of subject Section is standard brass cap monument with witnesses - set by B.L.M.
401.45' East and 28.9' North of mid-point between NW and NE Corners
West 1/4 Corner of subject Sec. not found but position confirmed by measurement and by illegible remains of bearing trees in reported locations
North 1/4 Corner reported at 40.12 chains - a post with a marked stone 12" in ground - Pits 18X18X12 east and west 5 1/2 feet - mound of earth 3' base 1 1/2' high around post.
No bearing trees. Now a brass cap set by B.L.M. In position shown on sketch on reverse.
NW Corner of subject Section is standard brass cap monument with witnesses - set by B.L.M.

DESCRIPTION OF MONUMENT AND ACCESSORIES ESTABLISHED
TO PERPETUATE THE ORIGINAL LOCATION OF THIS CORNER:

Date of work: 6-5-1968

SEE OTHER SIDE

SKETCH, WITH COURSE AND DISTANCE TO ADJACENT CORNERS IF DETERMINED IN THIS SURVEY.
(MAY SKETCH OR PASTE REPRODUCTION ON REVERSE SIDE.)

SEE OTHER SIDE

Surveyor's Seal

I, J. H. Ninneman
certify that the information shown herein is true and correct.

Jack H. Ninneman
Signature of Ground Party Chief

I, J. W. Ninneman 534 E.S.
certify that I have carefully performed or reviewed the work done on the diagrammed corner as reported on this recordation form and approve the same.

J. W. Ninneman
Signature of Surveyor 534 E.S.

DIAGRAM OF CORNER:

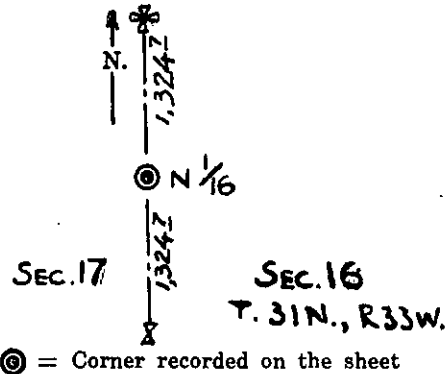

Registration Number

Office of Clerk and Recorder, County of Lincoln

This "corner record" was filed for record on the 24th day of September 1968, was noted on the cross-index plat and is assigned page No. 116, in book No. 1
ELEANOR L. VAUGHN, Mae Watson
County Official Deputy