

# CERTIFIED CORNER RECORDATION

CORNER \_\_\_\_\_ T. 31 N., R. 33 W., P.M.M. \_\_\_\_\_ LINCOLN COUNTY

RECORD:

NONE

FOUND EVIDENCE:

NONE

PERPETUATION:

Set a 5/8 inch dia. rebar with a 1 1/4 inch yellow plastic cap stamped K.E.D. 4975-S  
From Which

A 6 foot long steel post bears N7°W 3.75 ft. dist.

A 6 foot long steel post bears S32°E 3.3 ft. dist.

Attached bearing tree signs to post.

MAGNETIC DECLINATION: 18° E

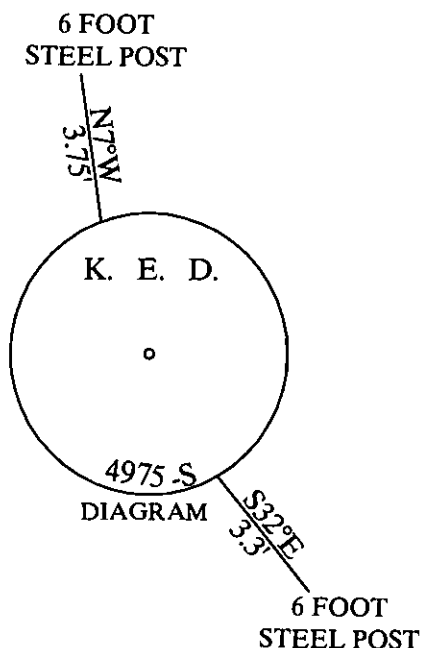

**CERTIFICATION**

I, George Clark  
Certify the information shown herein is true and correct  
Signature of Ground Party Chief

I, [Signature]  
certify that this Corner Record correctly represents work  
performed by me or under my direction in compliance with the  
"Corner Recordation Act"  
(70-22-101, et seq., M.C.A.)

**SEAL**  
KENNETH E. DAVIS  
Surveyor & Seal  
4975-S  
Davis Surveying Inc

## SKETCH OF CORNER

Office of Clerk and Recorder, County of \_\_\_\_\_

This "corner record" was filed for record on \_\_\_\_\_

was noted on the 226712 BOOK: CCR CC&R'S PAGE: 11526 Pages: 1

No. \_\_\_\_\_ STATE OF MONTANA LINCOLN COUNTY

In book No. \_\_\_\_\_ RECORDED: 06/23/2010 2:45 KOI: CC&R'S

TAMMY D. LAUER CLERK AND RECORDER

FEE: \$0.00

BY: [Signature]

TO: DAVIS SURVEYING, INC. P.O. BOX 896, TROY, MONTANA 59935

Cross Index No. \_\_\_\_\_ T. 31 N., R. 33 W., P.M.M.

SECTION

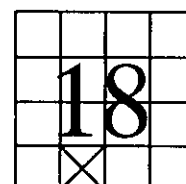

THIS CORNER