

# CERTIFIED CORNER RECORDATION

CORNER \_\_\_\_\_ T. 31 N., R. 33 W., P.M.M. \_\_\_\_\_ LINCOLN COUNTY

## RECORD:

NONE

## FOUND EVIDENCE:

NONE

## PERPETUATION:

Set a 5/8 inch dia. rebar with a 1 1/4 inch yellow plastic cap stamped K.ED. 4975-S  
From Which

A 6 foot long steel post bears N31°W 4.40 ft. dist.

A 6 foot long steel post bears S1°E 6.15 ft. dist.

Attached bearing tree signs to post.

MAGNETIC DECLINATION: 18° E

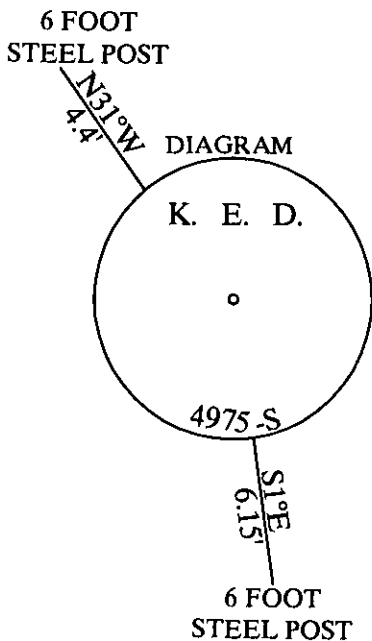

**CERTIFICATION**

I, George Clark  
 Certify the information shown herein is true and correct  
 Signature of Ground Party Chief

I, George Clark  
 certify that this Corner Record correctly represents work  
 performed by me or under my direction in compliance with the  
 "Corner Recordation Act"  
 (70-2501 MCA)  
 Signature of Surveyor & Seal  
 DAVIS  
 Employee of Davis Surveying Inc

## SKETCH OF CORNER

Office of Clerk and Recorder, County of \_\_\_\_\_

This "corner record" was filed for record on

was noted on the c No. \_\_\_\_\_

In book No. \_\_\_\_\_

226711 BOOK: CCR CCR'S PAGE: 11525 Pages: 1  
 STATE OF MONTANA LINCOLN COUNTY  
 RECORDED: 06/23/2010 2:44 KOI: CCR'S  
 TAMMY D. LAUER CLERK AND RECORDER  
 FEE: \$0.00 BY: Tammy D. Lauer  
 TO: DAVIS SURVEYING, INC. P.O. BOX 896, TROY, MONTANA 59938

## SECTION

	18	

Cross Index No. \_\_\_\_\_ T. 31 N., R. 33 W., P.M.M.

THIS CORNER