

CERTIFIED CORNER RECONSTRUCTION

CORNER _____ T. 31 N., R. 33 W., P.M.M. _____ LINCOLN COUNTY

RECORD:

A 5/8 inch dia. rebar with a 1 1/4 inch dia. Yellow Plastic Cap Stamped
K.E.D. 4975-S Per C.O.S. 1579

FOUND EVIDENCE:

A 5/8 inch dia. rebar with a 1 1/4 inch dia. Yellow Plastic Cap Stamped
K.E.D. 4975-S

PERPETUATION:

Established two new bearing objects for found monument
From Which

A 6 foot long steel post bears N40°E 3.95 ft. dist.

A 6 foot long steel post bears S4°E 4.85 ft. dist.

Attached bearing tree signs to posts.

MAGNETIC DECLINATION: 18° E

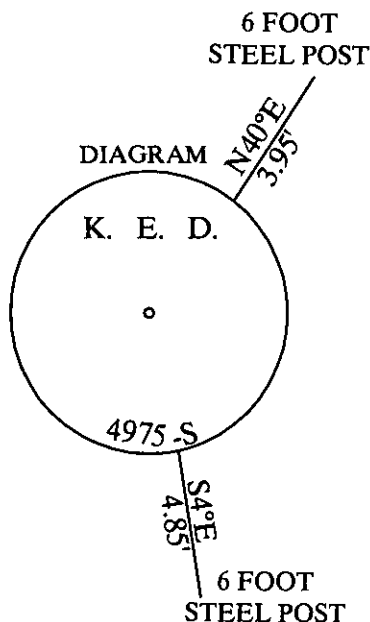

CERTIFICATION
I, George Clark
Certify the information shown herein is true and correct
Signature of Ground Party Chief
I, George Clark
certify that this Corner Record correctly represents work
performed by me or under my direction in compliance with the
"Corner Record Act" (M.C.A. 70-22-101, et seq.)
Signature of Surveyor & Seal
Date: 4/15/10 S. Reg. No. 4975-S
Davis Surveying Inc

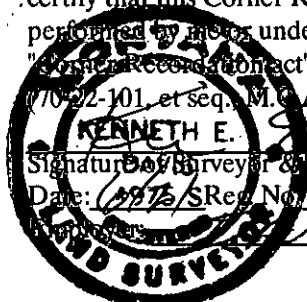

SKETCH OF CORNER

Office of Clerk and Recorder, County of _____

This "corner record" was filed for record on _____

was noted on the c 226710 BOOK: CCR CC&R'S PAGE: 11524 Pages: 1

No. _____ STATE OF MONTANA LINCOLN COUNTY

In book No. _____ RECORDED: 06/23/2010 2:43 KOI: CC&R'S

TAMMY D. LAUER CLERK AND RECORDER

FEE: \$0.00

BY: George Clark

TO: DAVIS SURVEYING, INC. P.O. BOX 896, TROY, MONTANA 59935

Cross Index No. _____ T. 31 N., R. 33 W., P.M.M.

SECTION

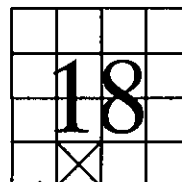

THIS CORNER