

CERTIFIED CORNER RECORDATION

CORNER _____ T. 31 N., R. 33 W., P.M.M. _____ LINCOLN COUNTY

RECORD:

A 5/8 inch dia. rebar with a 1 1/4 inch dia. Yellow Plastic Cap Stamped
K.E.D. 4975-S Per C.O.S. 1579

FOUND EVIDENCE:

A 5/8 inch dia. rebar with a 1 1/4 inch dia. Yellow Plastic Cap Stamped
K.E.D. 4975-S

PERPETUATION:

Established two new bearing objects for found monument
From Which

A 6 foot long steel post bears N18°W 4.8 ft. dist.

A 6 foot long steel post bears N90°W 3.73 ft. dist.

Attached bearing tree signs to posts.

MAGNETIC DECLINATION: 18° E

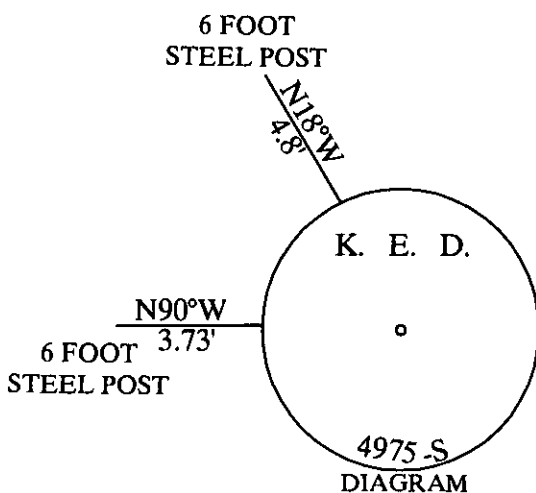

CERTIFICATION

I, George Clark
Certify the information shown herein is true and correct
Signature of Ground Party Chief

I, Kenneth E. Davis
certify that this Corner Record correctly represents work
performed by me or under my direction in compliance with the
"Corner Recordation Act"
(10-22-101, et seq., M.C.A.)

KENNETH E. DAVIS
Signature of Surveyor & Seal
Date: 6/23/2010 Reg. No. 4975-S
Employer: Davis Surveying Inc

SKETCH OF CORNER

Office of Clerk and Recorder, County of _____

This "corner record" was filed for record on _____

was noted on the _____ 226708 BOOK: CCR CC&R'S PAGE: 11522 Pages: 1

No. _____ STATE OF MONTANA LINCOLN COUNTY

In book No. _____ RECORDED: 06/23/2010 2:41 KOI: CC&R'S

TAMMY D. LAUER CLERK AND RECORDER

FEE: \$0.00

TO: DAVIS SURVEYING, INC. P.O. BOX 896, TROY, MONTANA 59935

Cross Index No. _____ T. 31 N., R. 33 W., P.M.M.

SECTION

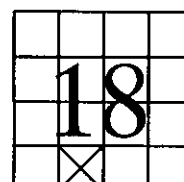

THIS CORNER