

# CERTIFIED CORNER RECORDATION

CORNER SW1/16 T. 31 N., R. 33 W., P.M.M. LINCOLN COUNTY

## RECORD:

Per Corner Recordation of J.N. 534 ES

Set 1/2"x 24" Steel Rod with cap stamped J.N. 534 ES

14" Fir bears S6°E 5.3 ft. scribed SW1/16 S28 BT and posted location poster on corner fence post N15E 3.1 ft.

## FOUND EVIDENCE:

Location poster and Fir bearing tree of J.N. 534 ES

## PERPETUATION:

A 5/8 inch dia. rebar 4 feet long with a 3 1/4 inch Aluminum Cap Stamped (see diagram below) Set per Section breakdown survey see Exhibit A & B last will & testament.

From Which

A 33 inch DBH Douglas Fir established by J.N. 534 bears S6°E 5.3 ft. dist.

A 6 foot Steel Fence Post bears N33°W 9.0 ft. dist.

A 6 foot Steel Fence Post bears N15°E 9.0 ft. dist.

MAGNETIC DECLINATION: 18° E

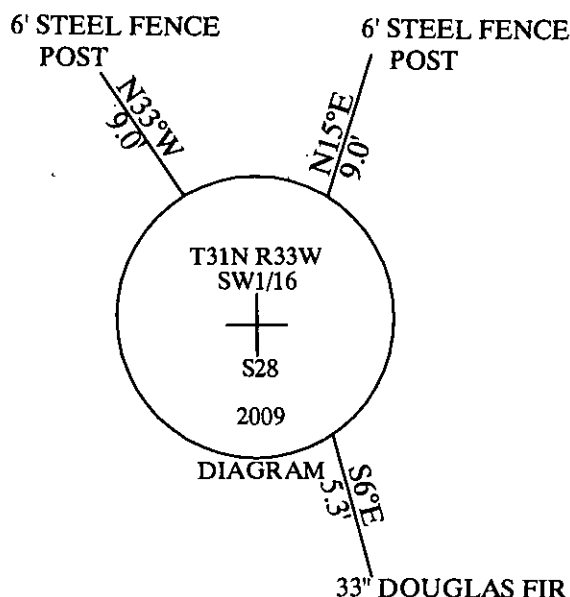

## CERTIFICATION

I, George Clark

Certify the information shown herein is true and correct  
Signature of Ground Party Chief

[Signature]

certify that this Corner Record correctly represents work performed by me or under my direction in compliance with the "Corner Recordation act" (70-27-101, et seq., M.C.A.)

[Signature]

Signature of Surveyor & Seal

Date: May Reg. No. 4975-5

Employer: Davis Surveying Inc

## SKETCH OF CORNER

Office of Clerk and Recorder, County of \_\_\_\_\_

This "Corner Recordation" was filed for record on \_\_\_\_\_ 226025 BOOK: CCR CC&R'S PAGE: 11509 Pages: 1

was recorded in the \_\_\_\_\_ STATE OF MONTANA LINCOLN COUNTY

No. \_\_\_\_\_ RECORDED: 05/14/2010 11:05 KOI: CC&R'S

In book \_\_\_\_\_ TAMMY D. LAUER CLERK AND RECORDER

FEE: \$0.00

BY: [Signature]

TO: DAVIS SURVEYING, INC. P.O. BOX 896, TROY, MONTANA 59935

## SECTION

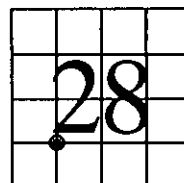

THIS CORNER

Cross Index No. \_\_\_\_\_ T. 31 N., R. 33 W., P.M.M.