

CERTIFIED CORNER RECORDATION

Corner: C 1/4, Sec. 32, Twp. 31 N., R. 33, W., P.M.M.

Lincoln County Montana

Record : See corner Rec. No. 872
See corner Rec. No. 3283

Found Evidence : A thorn apple 10 inch dia. (now 12 inch DBH) scribed C 1/4, S 32 BT.
A 5 inch dia. alder (now a 7 inch DBH) scribed C 1/4 S 32 BT. No monument was located per corner record No. 3283

Perpetuation :

Set a 5/8 inch dia. by 60 inch long rebar with a 3 1/4 inch aluminum cap stamped: (See diagram below) for the C 1/4 of Section 32.

Established two new bearing objects from which:

A 6 foot long steel fence post bears N. 63 E., 10.0 ft. dist.

A 6 foot long steel fence post bears N. 22 W., 12.9 ft. dist.

A 12 inch DBH Hawthorn bears N. 90 W., 19.5 dist. with St. Regis Location Poster

A 7 inch DBH Alder bears N. 33 E., 16.2 ft. dist. with a St. Regis Location Poster

Attached bearing tree signs to both posts.

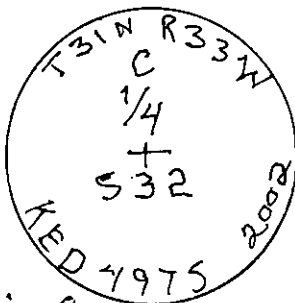
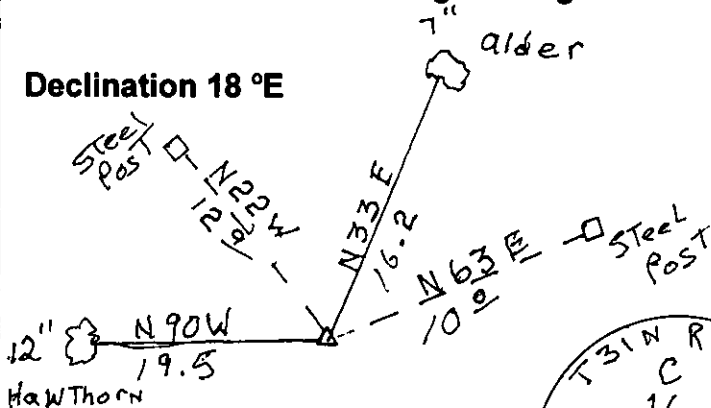

CERTIFICATION

I, **George Clark**

certify the information shown herein is true and correct

Signature of Ground Party Chief

I, **Robert M. Davis**
certify that this Corner Record correctly represents work performed by
Me, under my direct supervision, in compliance with the "Corner Recordation
Act."

Signature of Surveyor & Seal

Dated **11/26/02** Reg. No. **4975-S**

Employed by **Surveyors & Engineers, Inc.**

Section

Sketch of Corner

Office of Clerk and Recorder, County of **Lincoln**

This "corner record" was filed for record on **November 25, 02**

was noted on the cross-index plat and is assigned page No. **10571**

In book No. **County Official**

Cross Index No. C 1/4 Sec. 32, Twp. 31 N., R. 33 W., P.M.M.

• THIS CORNER

