

CERTIFIED CORNER RECORDATION

Corner Cor. 1 Sec. 16 T. 31N R. 32W P.M., MT Lincoln County
HES 579

- I. 1918 G.L.O. Original Homestead Entry Survey No. 579 by Harold Townsend: Set a small stone, mkd. with a cross (x), under a shale stone, 40x13x8 ins., 30 ins. in the ground, mkd. "1 HES 579" on the N.W. face, with a cross (X) mkd. on the top for the exact corner point.

Established two bearing trees:

A fir, 13 ins. diam., bears S50°01'W, 35 lks. dist., mkd. "1 HES 579 BT".
A pine, 14 ins. diam., bears N03°25'W, 19 lks. dist., mkd. "1 HES 579 BT".

Raise a mound of stone, 4 ft. base, 2 ft. high, N.W. of the corner.

- II. Found a stone, 9x5 ins., protruding 12 ins. above the ground, firmly set, mkd. as described in the original record.

from which:

A fir, 21 ins. diam., bears S50°W, 23.1 ft. dist., with a healed face. (record)
A root crown, bears N03°W, 12.5 ft. dist., with no visible marks. (record)

- III. Established one new bearing tree and set one steel guard post:

A p-pine, 23 ins. diam., bears S24°E, 35.9 ft. dist., mkd. "1 HES 579".
A 6 ft galvanized steel post, North, on property line, 3.0 ft. dist. from the stone.

Painted bearing trees and attached Land Survey Monument and Bearing Tree signs.
Attached Land Survey Monument and Property Boundary decals to the post.

Magnetic Declination: 20° East.

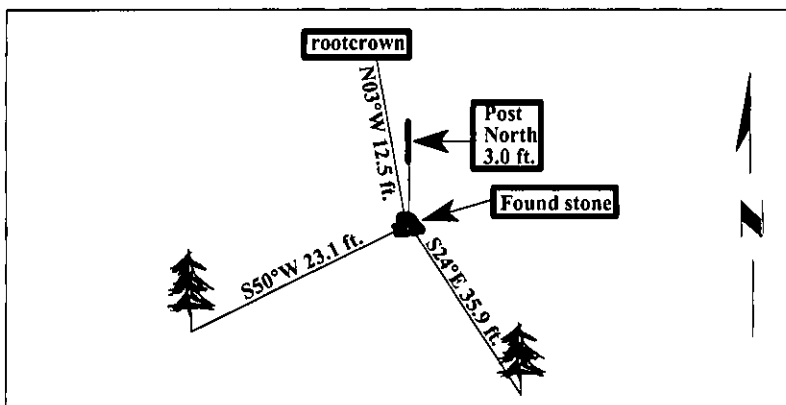

SKETCH OF CORNER

CERTIFICATION	
I. <u>Thomas Hommel</u>	certify the information shown herein is true and correct.
I. <u>Alvah F. Hughes</u>	certify that this Corner Record correctly represents work performed by me or under my direction in compliance with the "Corner Recordation Act" (70-22-101, et seq., M.C.A.)
<i>Alvah F. Hughes</i>	Signature of Surveyor Seal
Date: <u>07/21/97</u>	
Reg. No.: <u>7322LS</u>	
Employer: <u>U.S. FOREST SERVICE</u>	

Office of Clerk and Recorder, County of LINCOLN. This "corner record" was filed for record on AUG 21, 1997 was noted on the cross-index plat and is assigned page No. 9919 in book No. CORAL M. CUMMINGS By RLB

County Official

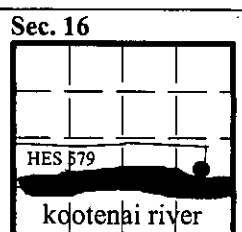

• - corner this sheet

Cross Index No. Cor. 1 T. 31N R. 32W P.M., MT
HES 579