

INSTRUCTIONS

1. Original and/or subsequent record used to evaluate the corner position.
2. Description of evidence found, note discrepancies in the record, state method of establishing lost or obliterated corners.
3. Description of monument and accessories set to perpetuate the corner position.
4. Sketch of corner, show all pertinent data which can best be shown in a sketch example, corner marking, topography ties, position of accessories, etc.
5. Certification must be signed and sealed by Land Surveyor registered in the State of Montana.
6. Fill in Cross Index & Section Diagram at bottom of sheet.

CERTIFIED CORNER RECORDATION

Corner 2 of HES 440 T. 31 N., R. 32 W., P.M.M. Lincoln County

I. 1915 H.E.S. original record by E. R. JOHNSON: Set stone and two bearing trees.

1922 H.E.S. amended survey record by J. F. PFOU: At Cor. No. 4 and CC of accepted H.E.S. No. 751, which is an iron post 2 ins. diam., 12 ins. above ground, I adopt this cor. for Cor. No. 2 and CC of this survey, marking it 2 HES 440 CC. From the point on top marking the exact cor. point:

- A cross (x) on a fir, 14 ins. diam., bears $S46^{\circ}00'W$, 41 links dist.
- A cross (x) on a fir, 5 ins. diam., bears $S82^{\circ}00'W$, 17 links dist.; each blazed and scribed 2 HES 440 BT.
- Raise a mound of earth and stone, 4 ft. base, 2 ft. high, on line $S5^{\circ}48'W$, 3 ft. dist.

Note: Cor. 2 as set in 1915 was not used for amended H.E.S. 440.

II. Found iron pipe, 2 ins. diam., 12 ins. above ground, firmly set, but leaning badly downhill, with brass cap mkd as shown:

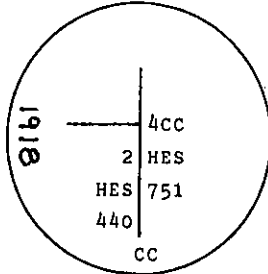

from which:

- A fir stump, bears $S46^{\circ}W$, 27.0 ft. dist. (40.9 lks.), no visible marks.
- A fir, bears $S82^{\circ}W$, 11.4 ft. dist. (17.2 lks.), mkd. with an "X". (being used for a fence cor.)

III. At the position of the base of the iron pipe and verified by the bearing trees, set a 30 in. long, 2 1/2 in. diam., aluminum pipe, with a 3 1/4 in. U.S.D.A. Forest Service aluminum cap mkd. as shown:

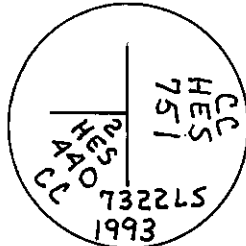

Establish two new bearing trees:

- A fir, 14 ins. diam., bears $S86^{\circ}E$, 8.3 ft. dist., mkd. 2 HES 440 CC BT.
- A larch, 14 ins. diam., bears $N29^{\circ}W$, 17.3 ft. dist., mkd. 2 HES 440 CC BT.

Painted a red band around the bearing trees and attached Land Survey Monument and Bearing Tree signs. Set a 6 ft. galvanized steel guard post with Land Survey Marker and Property Boundary decals, WEST, 4 ft. Magnetic declination: 20° East

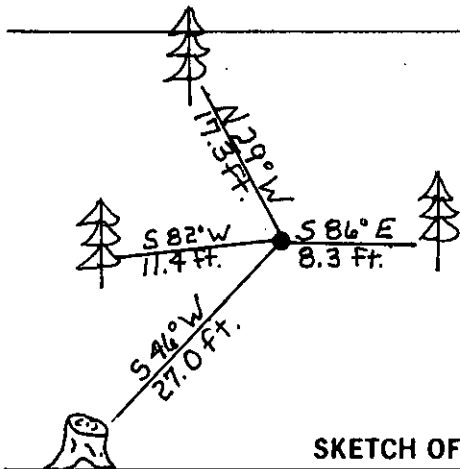

SKETCH OF CORNER

CERTIFICATION

1. Kenneth K. Kern
 certify the information shown herein to be true and correct.
Kenneth K. Kern
 Signature Ground Party Chief

2. Alvah F. Hughes
 certify that this Corner Record correctly represents work performed by me or under my direction in compliance with the "Corner Recordation Act" (70-22-101 et seq., M.C.A.)
Alvah F. Hughes
 Signature of Surveyor & Seal 322LS

Date: 1/3/94 Reg. No. 7322LS
 Employer: U.S. FOREST SERVICE

Office of Clerk and Recorder, County of Lincoln. This "corner record" was filed for record on March 6, 1994 was noted on the cross-index plat and is assigned page No. 6214, in book No. _____

Coral M. Cummings
 County Official

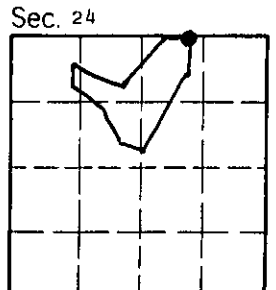

Cross Index No. 2 HES 440 T. 31N R. 32W PMM

• - corner this sheet