

INSTRUCTIONS

1. Original and/or subsequent record used to evaluate the corner position.
2. Description of evidence found, note discrepancies in the record, state method of establishing lost or obliterated corners.
3. Description of monument and accessories set to perpetuate the corner position.
4. Sketch of corner, show all pertinent data which can best be shown in a sketch example, corner marking, topography ties, position of accessories, etc.
5. Certification must be signed and sealed by Land Surveyor registered in the State of Montana.
6. Fill in Cross Index & Section Diagram at bottom of sheet.

CERTIFIED CORNER RECORDATION

Corner 9 of HES 744 T. 31 N. R. 32 W. P.M.M. Lincoln County

I. 1918 HES record by Harold Townsend: "Set a small stone, marked with a cross (x) under a quartzite stone, 26x10x5 ins. 16 ins. in the ground marked 9 HES 744 on SE face and a cross (X) on top, from which

A cross (x) on a lodgepole pine tree, 5 ins. in dia., bears $N34^{\circ}21'E$, 42 links. distance.
 A cross (x) on a lodgepole pine tree, 5 ins. in dia., bears $S41^{\circ}13'E$, 23 links distance each blazed and scribed 9 H.E.S. 744 B.T.
 Raise a mound of stone 4 ft. base, 2 ft. high, SE of corner.

II. Found a stone, 10x4 ins., 9 ins. above the ground, firmly set, marked X on top, 9 HES 744 on the SE face, from which

A dead pine, 12 ins. diam., bears $S41^{\circ}E$, 15.2 ft. (23 lks.) dist., healed face.
 Mound of stone, SE, 2 ft. of corner.

III. Established two new bearing trees:

A fir, 10 ins. diam., bears $N43^{\circ}E$, 15.6 ft. dist., mrk. 9 HES 744 BT.
 A fir, 8 ins. diam., bears $N34^{\circ}W$, 33.2 ft. dist., mrk. 9 HES 744 BT.

Painted red bands around the bearing trees and attached Land Survey Monument and Bearing Tree signs.

Set a 6 ft. galvanized steel guard post with Land Survey Marker and Property Boundary decals, E. 3 ft.

Rebuild mound of stone SE of corner.

Magnetic declination: 20° East

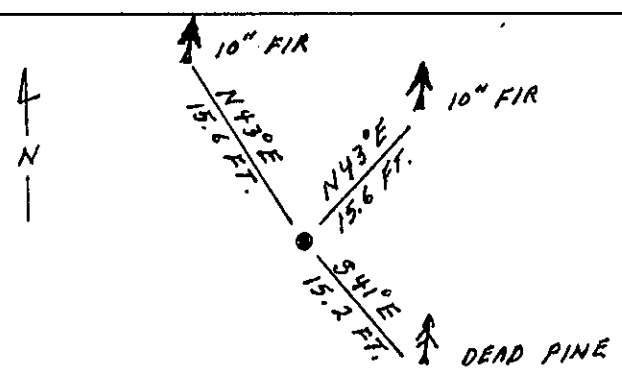
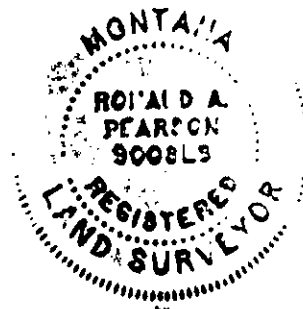

SKETCH OF CORNER

CERTIFICATION

I, Thomas M. Hommel
 certify the information shown herein is true and correct.
 Signature Ground Party Chief

I, Ronald A. Pearson
 certify that this Corner Record correctly represents work performed by me or under my direction in compliance with the "Corner Recordation Act" (70-22-101, et seq., M.C.A.)
 Signature of Surveyor & Seal

Date: 12/9/92 Reg. No. 9008LS
 Employer: U.S. FOREST SERVICE

Office of Clerk and Recorder, County of Lincoln. This "corner record" was filed for record on 12-21-92 was noted on the cross-index plat and is assigned page No. 5208, in book No. _____
Carol M. Cummings by BB
 County Official

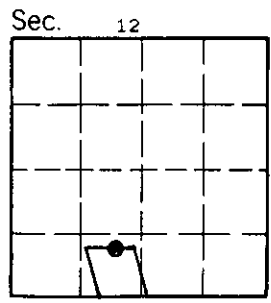

Cross Index No. 9 HES 744 T. 31 N R. 32 W P.M.M.

• - corner this sheet