

INSTRUCTIONS

1. Original and/or subsequent record used to evaluate the corner position.
2. Description of evidence found, note discrepancies in the record, state method of establishing lost or obliterated corners.
3. Description of monument and accessories set to perpetuate the corner position.
4. Sketch of corner, show all pertinent data which can best be shown in a sketch example, corner marking, topography ties, position of accessories, etc.
5. Certification must be signed and sealed by Land Surveyor registered in the State of Montana.
6. Fill in Cross Index & Section Diagram at bottom of sheet.

CERTIFIED CORNER RECORDATION

Corner 4 of HES 744 T. 31 N. R. 32 W. P.M.M. Lincoln County

- I. 1918 HES 744 record by Harold Townsend: Set a stone, mark two bearing trees and raise mound of earth.
1918 HES 751 record by Harold Townsend: Previous set stone, mark 5 HES 751, mark two bearing trees and raise a mound of stone.

1970 Certified Recordation by Stanley J. Skousen: "Found original stone firmly set and plainly marked (Record - set a quartzite stone 26x10x10 ins. 16 ins. in the ground, with a cross (X) on top, marked 5 HES 751 on SE face, marked 4 HES 744 on NW face), from which:

A cross (x) on a fir tree, 15 in. diam. bears N4°50'W - 84 lks. dist., alive and overgrown.

(Record - A cross (X) on a fir tree 5 in. diam., bears N4°50'W - 84 lks. dist., blazed and scribed 4 HES 744 BT)

A fir, 16 in. diam., bears S71°23'E - 9.5 lks. dist., stump with scribing visible.

(Record - A cross (X) on a fir tree, 15 ins. in diam., bears S71°23'E - 9.5 lks. dist. blazed and scribed 5 HES 751 BT)

A lodgepole pine, 12 in. diam., bears S4°22'W - 87.5 lks. dist., stump with scribing visible.

(Record - A cross (X) on a lodgepole pine tree, 8 ins. in diam., bears S4°22'W, 87.5 lks. dist., blazed and scribed 5 HES 751 BT)

Corner common to cors. 4 HES 744 and 5 HES 751. I set a 2 in. galvanized iron pipe, 24 inches in the ground, with brass cap marked.

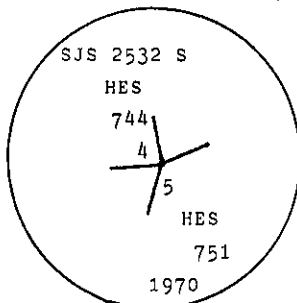

I buried the original corner stone alongside the iron pipe, from which:

A larch, 8 ins. diam., bears N61°E - 18 lks. dist., marked RM.

I placed signs and paint on BT's and placed an iron fence post alongside the iron pipe with signs attached."

- II. Found a 2 ins. diam. iron pipe, 8 ins. above the ground with 2 1/2 ins. diam. brass cap marked as shown above, from which:

A fir, 18 ins. diam., bears N5°W., 55.4 ft. (84 lks.) dist., healed face. (HES 744 record)

A larch, 12 ins. diam., bears N61°E., 12.0 ft. (18 lks.) dist., healed face. (1970 record)

A larch, 21 ins. diam., bears S12°W., 4.3 ft. (7 lks.) dist., visible scribe marks. (no record)

A fir stump, bears N71°E., 7.1 ft. (11 lks.) dist., axed face. (no record)

A fir stump, bears S65°E., 6.5 ft. (10 lks.) dist., mkd. 751 BT. (HES 751 record: S71°23'E, 9.5 lks.)

A pine stump, 10 ins. diam., bears S6°E., 58.0 ft. (86 lks.) dist., mkd. 5 HES 751 BT. (HES 751 record: S4°22'W, 87.5 lks.)

- III. This recordation notes found B.T. of no previous record.

Painted red bands around the bearing trees and attached Land Survey Monument and Bearing Tree signs.
 Magnetic declination: 20° East

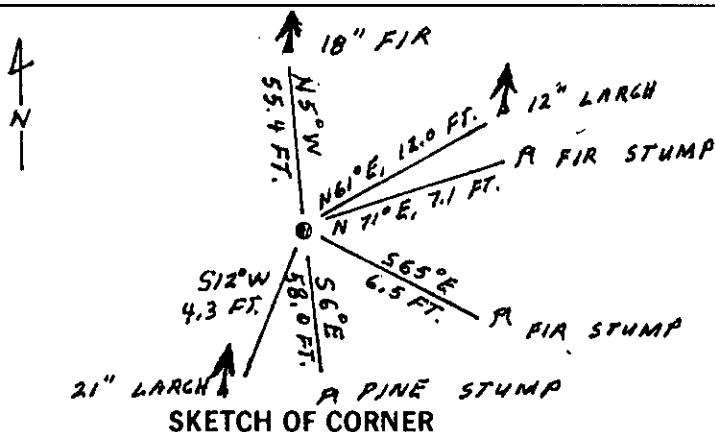

SKETCH OF CORNER

CERTIFICATION

1. Thomas M. Hommel
 certify the information shown herein is true and correct.

Thomas M. Hommel
 Signature Ground Surveyor

1. Ronald A. Pearson
 certify that this Corner Record correctly represents the corner as shown by me or under my direction in compliance with the Corner Recordation Act" (70-22-101 et seq., M.C.A.)

Ronald A. Pearson
 Signature of Surveyor & Seal

Date: 12/9/92 Reg. No. 9008LS

Employer: U.S. FOREST SERVICE

Office of Clerk and Recorder, County of Lincoln. This "corner record" was filed for record on 12-21-92 was noted on the cross-index plat and is assigned page No. 5207, in book No. Corral M Cummings by BBS

County Official

4 HES 744 31 N 32 W
 Cross Index No. T. R. PMM

Sec. 13

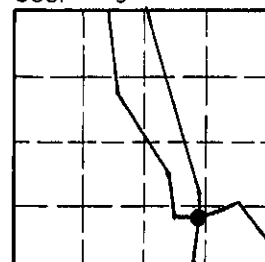

• - corner this sheet