

INSTRUCTIONS

1. Original and/or subsequent record used to evaluate the corner position.
2. Description of evidence found, note discrepancies in the record, state method of establishing lost or obliterated corners.
3. Description of monument and accessories set to perpetuate the corner position.
4. Sketch of corner, show all pertinent data which can best be shown in a sketch example, corner marking, topography ties, position of accessories, etc.
5. Certification must be signed and sealed by Land Surveyor registered in the State of Montana.
6. Fill in Cross Index & Section Diagram at bottom of sheet.

CERTIFIED CORNER RECORDATION

Corner 21 of HES 744 T. 31 N. R. 32 W. P.M.M. Lincoln County

I. 1918 HES 744 record by Harold Townsend: "Set a small stone, marked with a cross (X) under an iron post 2 ins. in dia. 36 ins. long, 24 ins. in the ground with a brass cap, marked 1918, 21 H.E.S. 744 and a point on top, from which

A cross (x) on a fir tree, 5 ins. in dia., bears $S59^{\circ}51'E$, 17.5 links distance.
 A cross (x) on a fir tree, 9 ins. in dia., bears $S23^{\circ}44'E$, 31 links distance.
 each blazed and scribed 21 H.E.S. 744 B.T.
 Raise a mound of stone 4 ft. base, 2 ft. high, SE of corner."

II. Found a 2 ins. diam. iron pipe, 12 ins. above the ground with 2 1/2 ins. diam. U.S.F.S. brass cap, marked as shown:

21
 HES
 744
 1918

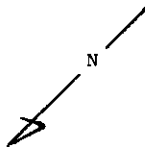

from which

Rotten remains, bears $S60^{\circ}E$, 11.5 ft. (17.4 lks.) dist., no visible scribe.
 A fir, 19 ins. diam., bears $S24^{\circ}E$, 20.5 ft. (31 lks.) dist., healed face.

III. Established one new bearing tree:

A fir, 13 ins. diam., bears $N68^{\circ}W$, 29.1 ft. dist., mrk. 21 HES 744 BT.

Painted red bands around the bearing trees and attached Land Survey Monument and Bearing Tree signs.

Set a 6 ft. galvanized steel guard post with Land Survey Marker and Property Boundary decals, $S19^{\circ}E$, 3 ft.

Magnetic declination: 20° East

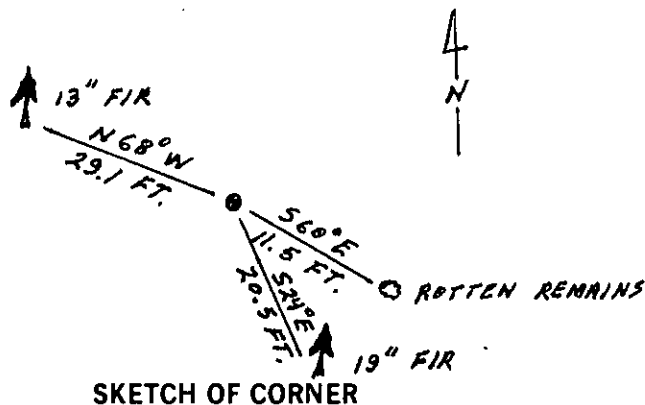
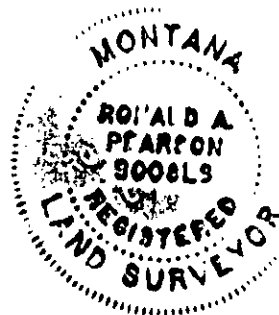

SKETCH OF CORNER

CERTIFICATION
 I, Thomas M. Hommel
 certify the information shown herein is true and correct
Thomas M. Hommel
 Signature Ground Party Chief
 I, Ronald A. Pearson
 certify that this Corner Record correctly represents work performed by me or under my direction in compliance with the "Corner Recordation Act" (70-22-101, et seq., M.C.A.)
Ronald A. Pearson
 Signature of Surveyor & Seal
 Date: 12/9/92 Reg. No. 9008LS
 Employer: U.S. FOREST SERVICE

Office of Clerk and Recorder, County of Lincoln. This "corner record" was filed for record on 12-21-92 was noted on the cross-index plat and is assigned page No. 5205, in book No. Coral M. Cummings by H.B.

County Official

21 HES 744 31 N 32W
 Cross Index No. _____ T. _____ R. _____ P.M.M.

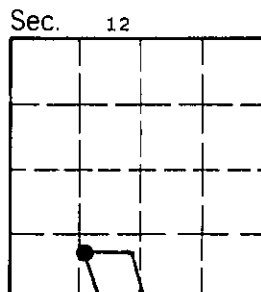

• - corner this sheet