

INSTRUCTIONS

1. Original and/or subsequent record used to evaluate the corner position.
2. Description of evidence found, note discrepancies in the record, state method of establishing lost or obliterated corners.
3. Description of monument and accessories set to perpetuate the corner position.
4. Sketch of corner, show all pertinent data which can best be shown in a sketch example, corner marking, topography ties, position of accessories, etc.
5. Certification must be signed and sealed by Land Surveyor registered in the State of Montana.
6. Fill in Cross Index & Section Diagram at bottom of sheet.

CERTIFIED CORNER RECORDATION

Corner 16 of HES 744 T. 31 N. R. 32 W. Lincoln County

- I. 1915 HES 440 record by Elmer R. Johnson: "Set for Cor. No. 6, a quartzite stone 26x12x6 ins., 16 ins. in the ground, marked 6 H.E.S. 440 on SE. face, and a cross (x) on top for the exact corner point, from which

A cross (x) on a cedar, 18 ins. dia., bears S52°52'E, 37 lks. dist.

A cross (x) on a cedar, 9 ins. dia., bears N42°10'E, 45 lks. dist., each blazed and scribed 6 H.E.S. 440 B.T.

Raise a mound of stone, 4 ft. base, 2 ft. high, SE of corner."

- 1918 HES 744 record by Harold Townsend: "Intersect Cor. No. 6 of H.E.S. No. 440 ... I adopt this Cor. for Cor. No. 16 of this survey and mark the stone 16 H.E.S. 744 on the NE. face, from the cross (x) on top.

A cross (x) on a cedar tree, 18 ins. in dia., bears S52°53'E, 37 links distance (Old BT)

A cross (x) on a cedar tree, 9 ins. in dia., bears N42°12'E, 45 links distance (Old BT), each blazed and scribed 16 H.E.S. 744 B.T.

Raise a mound of earth 4 ft. base, 2 ft. high, NE of corner."

- II. Found a stone, 15x5 ins., 8 ins. above the ground loosely set and slid downhill, marked X on top and 16 HES 744 on the NE face, from which

Rotten remains of cedar stump, bears S52°E, 23.0 ft. (35 lks.) dist., no visible scribe. (Record: 37 lks.)

Rotten remains of cedar stump, bears N42°E, 29.7 ft. (45 lks.) dist., no visible scribe. (Record)

- III. At corner point, set a 2 1/2 ins. diam., 30 ins. long aluminum pipe, 18 ins. in the ground with 3 1/4 ins. diam., U.S.D.A. Forest Service aluminum cap marked as shown:

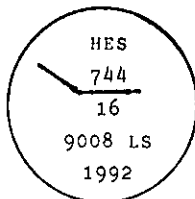

Established two new bearing trees:

A cedar, 12 ins. diam., bears S23°W, 27.6 ft. dist., mrk. 16 HES 744 BT.

A cedar, 8 ins. diam., bears N40°W, 19.6 ft. dist., mrk. 16 HES 744 BT.

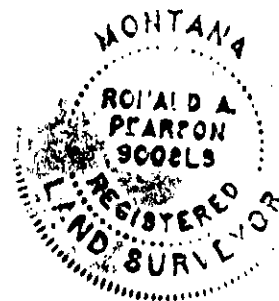

Painted red bands around the bearing trees and attached Land Survey Monument and Bearing Tree signs.

Set a 6 ft. galvanized steel guard post with Land Survey Marker and Property Boundary decals.

N8°55'W, 5 ft.

Magnetic declination: 20° East

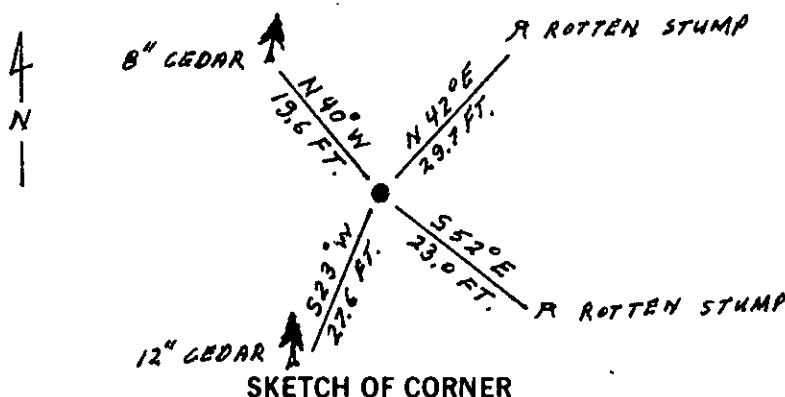

CERTIFICATION

Thomas M. Hommel

I, Thomas M. Hommel

certify the information shown herein is true and correct.

Thomas M. Hommel
Signature Ground Party Chief

Ronald A. Pearson

I, Ronald A. Pearson
certify that this Corner Record correctly represents work performed by me or under my direction in compliance with the "Corner Recordation Act" (70-22-101, et seq., M.C.A.)

Ronald A. Pearson
Signature of Surveyor & Seal

12/9/92 9008LS

Date: 12/9/92 Reg. No. 9008LS

Employer: U.S. FOREST SERVICE

Office of Clerk and Recorder, County of Lincoln. This "corner

record" was filed for record on 12-21-92

was noted on the cross-index plat and is assigned page No. 5199, in

book No. Coral M Cummings by BB

County Official

16 HES 744

31 N 32W

Cross Index No. T. R. PMM

Sec. 13

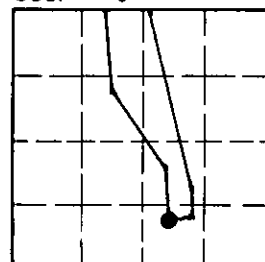

• - corner this sheet