

INSTRUCTIONS

1. Original and/or substituted record used to evaluate the corner position.
2. Description of evidence found, note discrepancies in the record, state method of establishing lost or obliterated corners.
3. Description of monument and accessories set to perpetuate the corner position.
4. Sketch or corner, show all pertinent data which can best be shown in a sketch example, corner marking, topography ties, position of accessories, etc.
5. Certification must be signed and sealed by Registered Land Surveyor in State of Montana.
6. Fill in Cross Index & Section Diagram at bottom of sheet.

CERTIFIED CORNER RECORDATION

Corner #1 HES 443 T. 31N R. 32W P.M.M. Lincoln County

ORIGINAL U.S.D.A. NOTES: 1916

CORNER: Sandstone 28 x 12 x 8 inches, 18" in the ground, marked MC on S. face; 1 HES 443 on N. face, an X on top
A 15" Fir bears S.69°05'W., 5 lks

EVIDENCE FOUND: 6" x 12" x 23" slate stone, top broken, marked 4+ on N. face with cross on top
13" stump bears S.79°W., 3.7 feet

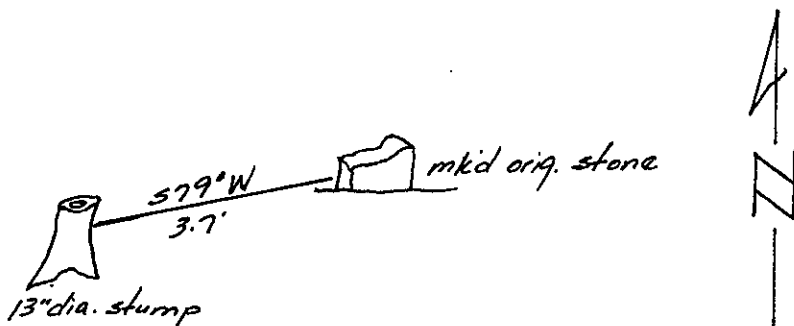

SKETCH OF CORNER

CERTIFICATION

I, _____
certify the information shown herein is true and correct.

Robert S. Custer, P.L.S.

I, _____
certify that this Corner Record correctly represents work performed by me or under my direction in compliance with the "Corner Recordation Act" (70-2740, 1908, M.D.A.)

Date: 11/30/2019
Employer: Professional Consultants, Inc.

Office of Clerk and Recorder, County of Lincoln. This "corner record" was filed for record on the January 21st day of 1982 was noted on the cross-index plat and is assigned page No. 1510, in book No. 1

Eleanor L. Laughlin by Betty L. Conces
County Official deputy

Cross Index No. L, M-4, 5 T. 31N R. 32W P.M.M.

Sec. 18 - Unsurveyed

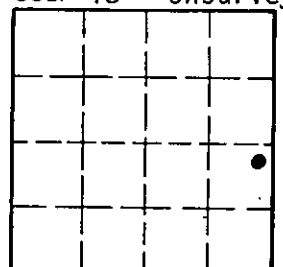

• - corner this sheet