

INSTRUCTIONS

1. Original and/or subsequent record used to evaluate the corner position.
2. Description of evidence found, note discrepancies in the record, state method of establishing lost or obliterated corners.
3. Description of monument and accessories set to perpetuate the corner position.
4. Sketch or corner, show all pertinent data which can best be shown in a sketch example, corner marking, topography ties, position of accessories, etc.
5. Certification must be signed and sealed by Registered Land Surveyor in State of Montana.
6. Fill in Cross Index & Section Diagram at bottom of sheet.

CERTIFIED CORNER RECORDATION

Corner #2 HES 443 T. 31N R. 32W P.M.M. Lincoln County

ORIGINAL U.S.D.A. NOTES: 1916

CORNER: Quartzite stone 26" x 10" x 6", 16" in ground marked 2 HES 443 on SE face, X on top
 12" Yellow Pine bears S.32°52'W., 90 lks
 15" Yellow Pine bears N.33°05'W., 100 lks
 Mound of stone, 4 ft. base, 3 ft. high, SE of corner

EVIDENCE FOUND: Quartzite stone 10" x 10" x 6", firmly set in ground with "X" on top
 24" Pine bears S.34°W., 58.0 feet
 25" Pine bears N.31°W., 59.0 feet

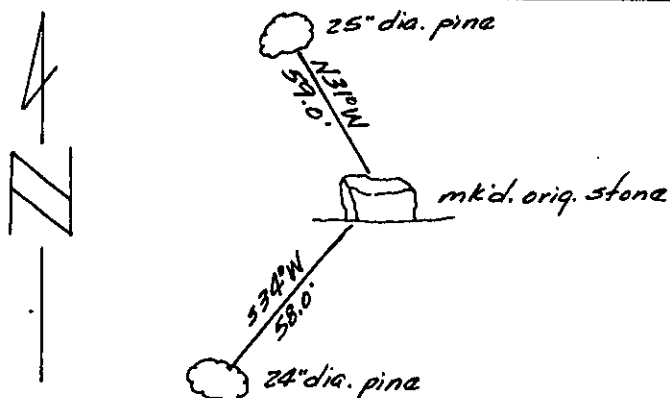

SKETCH OF CORNER

CERTIFICATION

I, _____
 certify the information shown herein is true and correct.

1. Robert J. Conner, PLS
 certify that this Corner Record correctly represents work performed
 by me or under my direction in compliance with the "Corner
 Recordation Act" (22-2-201, et seq., M.C.A.)

Signature of Surveyor: Robert J. Conner
 Date: 11/30/82
 Employer: Professional Consultants, Inc.

Office of Clerk and Recorder, County of Lincoln. This "corner
 record" was filed for record on the January 21st day of 1982
 was noted on the cross-index plat and is assigned page No. 1509, in
 book No. 1

Eleanor L. Vaughn by Betty L. Conner
 County Official deputy

Cross Index No. K, L-4, 5 T. 31N R. 32W P.M.M.

Sec. 18 - Unsurveyed

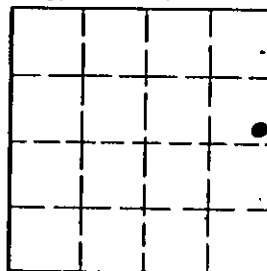

• corner this sheet