

INSTRUCTIONS

1. Original and/or substituted record used to evaluate the corner position.
2. Description of evidence found, note discrepancies in the record, state method of establishing lost or obliterated corners.
3. Description of monument and accessories set to perpetuate the corner position.
4. Sketch of corner, show all pertinent data which can best be shown in a sketch example, corner marking, topography ties, position of accessories, etc.
5. Certification must be signed and sealed by Registered Land Surveyor in State of Montana.
6. Fill in Cross Index & Section Diagram at bottom of sheet.

CERTIFIED CORNER RECORDATION

Corner 10 HES 579 T. 31N R. 32W P.M.M. Lincoln County

ORIGINAL G.L.O. NOTES: 1918

CORNER: Quartzite stone 27 x 10 x 4 inches, 17" in ground, marked 10 HES 579 on NE face, X on top
 21" Fir bears N.10°05'W., 180 lks
 17" Tamarack bears S.89°23'W., 81 lks
 Mound of stones, 4 ft. base, 2 ft. high, NE of corner

EVIDENCE FOUND: Quartzite stone 10 x 10 x 4 inches, marked 10 HES 579 on NE face, X on top
 Rotten stump bears N.10°W., 118.8 feet
 Rotten stump bears S.89°W., 53.5 feet

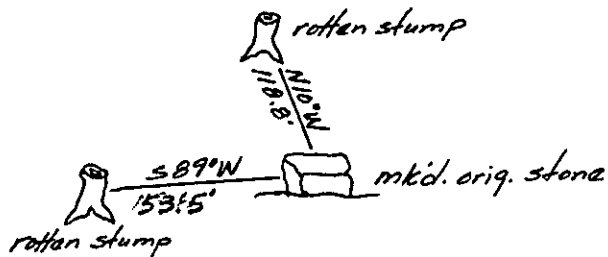

SKETCH OF CORNER

CERTIFICATION

I, _____
 certify the information shown herein is true and correct.

Robert M. Custer, P.E.S.

I, _____
 certify that this Corner Record correctly represents work performed by me or under my direction in compliance with the "Corner Recordation Act" (22-2201, M.C.A.)

Date: 11/30/2019

Employer: Professional Consultants, Inc.

Office of Clerk and Recorder, County of Lincoln. This "corner record" was filed for record on the January 21st day of 1982 was noted on the cross-index plat and is assigned page No. 1507, in book No. 1

Eleanor L. Vaughn by Betty L. Conner
 County Official & deputy

Cross Index No. L, M-8, 9 T. 31N R. 32W P.M.M.

Sec. 17 - Unsurveyed

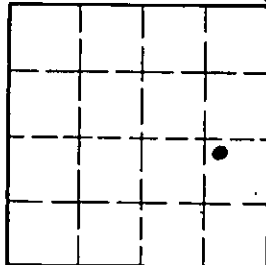

• - corner this sheet