

INSTRUCTIONS

1. Original and/or subrecord used to evaluate the corner position.
2. Description of evidence found, note discrepancies in the record, state method of establishing lost or obliterated corners.
3. Description of monument and accessories set to perpetuate the corner position.
4. Sketch or corner, show all pertinent data which can best be shown in a sketch example, corner marking, topography ties, position of accessories, etc.
5. Certification must be signed and sealed by Registered Land Surveyor in State of Montana.
6. Fill in Cross Index & Section Diagram at bottom of sheet.

CERTIFIED CORNER RECORDATION

Corner 7 HES 935 T. 31N R. 32W P.M.M. Lincoln County

ORIGINAL USDA NOTES: USDA - Forest Service 1919

CORNER: 26 x 12 x 7 inch stone marked 17 HES 935 SW face, X on top of stone
 "X" on 9" dia. Pine tree, bears S.48°07'E., 92 lks
 "X" on 9" dia. Pine tree, bears N.10°23'W., 48 lks
 Each blazed & scribed 7 HES 935 BT

EVIDENCE FOUND: 12 x 7 inch stone marked 7 HES 935, SW face
 16" Pine with blaze bears S.49°E., 61.0 feet distance with K-tag
 15" Pine with blaze bears N.10°W., 31.5 feet with K-tag

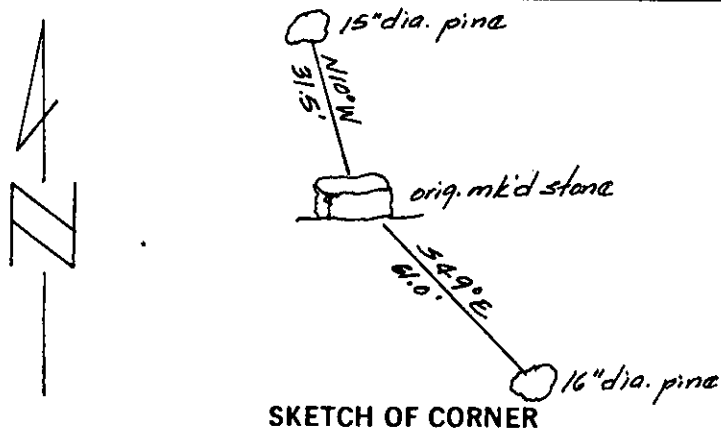

CERTIFICATION

I, _____
 certify the information shown herein is true and correct.

Signature of County Party Chief

1. Robert S. Winter

certify that this Corner Record represents work performed by me or under my direction in compliance with the "Corner Recordation Act" (MCA, § 82-2-1, MCA, § 82-2-2).

Signature of Surveyor Seal
 Date: 11/30/81 Reg. No. 33259

Employer: Professional Consultants, Inc.

Office of Clerk and Recorder, County of Lincoln. This "corner record" was filed for record on the January 21st day of 1987 was noted on the cross-index plat and is assigned page No. 1496, in book No. _____

Eleanor L. Vaughn by Betty L. Conner
 County Official deputy

Cross Index No. M, N-20,22 T. 31N R. 32W P.M.M.

Sec. 13

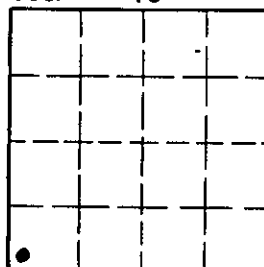

• - corner this sheet