

INSTRUCTIONS

1. Original and/or subsequent record used to evaluate the corner position.
2. Description of evidence found, note discrepancies in the record, state method of establishing lost or obliterated corners.
3. Description of monument and accessories set to perpetuate the corner position.
4. Sketch of corner, show all pertinent data which can best be shown in a sketch example, corner marking, topography ties, position of accessories, etc.
5. Certification must be signed and sealed by Land Surveyor registered in the State of Montana.
6. Fill in Cross Index & Section Diagram at bottom of sheet.

CERTIFIED CORNER RECORDATION

Corner Cor. No. 3 HES 751 T. 31 North R. 32 West P.M.M. Lincoln County

ORIGINAL – E.R. Johnson – 1915 HES 440

I destroy the listing corner and its accessories and set for Cor. No. 4 HES 441 a quartzite stone 28x10x10 inches, 18" in the ground marked 4 HES 441 on Southeast face and a cross (X) on top for the exact corner point; from which:
 A cross (X) on a Yellow Pine, 20" diameter, bears S48°3'W, 25 links (16.5') distant.
 A cross (X) on a Red Fir, 18" diameter, bears N34°05'W, 3 links (1.98') distant.
 Each blazed and scribed 4 HES 441 BT.

Harold Townsend – 1918 HES 751

Intersect Cor. No. 4 of HES 441, identical with Cor. No. 1 of HES 440, which is a quartzite stone 10x10x9 inches above the ground with a cross (X) on top marked and witnessed as described.....I adopt this corner for Cor. No. 3 of this survey and mark the stone 3 HES 751 on Northeast face from the cross (X) on the stone.
 A cross (X) on a cedar tree, 6" diameter, bears N62°04'E, 37.5 links (24.75') distant.
 A cross (X) on a fir tree, 7" diameter, bears N6°18'E, 39 links (25.74') distant.
 Each blazed and scribed 3 HES 751 BT.
 Raise a mound of stone 4' base, 2' high, northeast of corner.

FOUND:

Found original stone 11"x8"x8" above ground marked with 1 HES 440 on North face, 4 HES 441 on Southeast face, 3 HES 751 on Northeast face.
 A 28" diameter cedar with visible scribing bears N61½°E, 25.57 feet distant to aluminum nail in side center of tree.
 A 24" fir stump with visible scribing bears N42°W, 26.13 feet distant to aluminum nail in side center of tree.

ESTABLISH:

A 10" diameter Douglas Fir bears S37½°E, 26.02' distant to aluminum nail in side center of tree, blaze and scribe 4 HES 441 BT.
 Paint bearing trees with red paint and attach bearing tree tags.

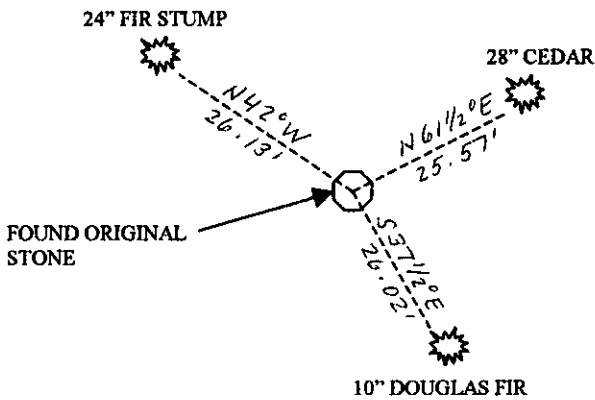

SKETCH OF CORNER

CERTIFICATION

I, James R. Staples
 Certify the information shown herein is true and correct.

James R. Staples
 Signature Ground Party Chief

I, James R. Staples
 certify that this Corner Record correctly represents work performed by me or under my direction in compliance with the "Corner Recordation Act" (70-22-101, et seq., M.C.A.)

James R. Staples
 Signature of Surveyor & Seal

Date: 2/11/05 Reg. No. 9958 LS

Employer: J.R.S. Surveying, Inc.

Office of Clerk and Recorder County of _____ This "corner
 185531 BOOK: CCR CC&R'S PAGE: 10795 Pages: 1
 record" was filed STATE OF MONTANA LINCOLN COUNTY
 was noted on the RECORDED: 06/28/2005 10:05 KOI: CC&R'S
 book no. _____ CORAL M. CUMMINGS CLERK AND RECORDER
 FEE: \$0.00 BY: *Geannie Dennis*
 TO: FILED _____ Deputy
 County Official

			COR #3	HES 751
		24		

Cross Index No. _____ T. 31N R. 32W PMM