

**CERTIFIED LAND CORNER RECORDATION**  
(REFERENCE FSM 7153.53)

DESCRIPTION OF CORNER EVIDENCE FOUND, AND ORIGINAL RECORD (IF KNOWN)

No previous record

DESCRIPTION OF MONUMENT AND ACCESSORIES ESTABLISHED TO PERPETUATE THE ORIGINAL LOCATION OF THIS CORNER:

Date of work: Nov 1980

Set 2 1/2" X 30" Aluminum pipe with cap marked:  
Raised a collar of stone around cap.

- From which: 8" Pine bears S24°W, 5.8' marked X BT
- 12" Pine bears N75°E, 34.1' marked CE1/16 S34 BT
- 6" Pine bears S76°W, 5.0' Location poster attached

Attached signs and painted a 6" red band around trees.  
Placed a post next to corner with National Forest Boundary sign.

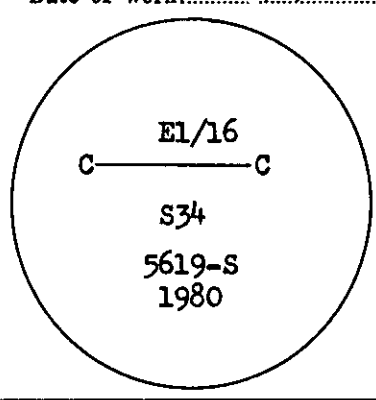

SKETCH, WITH COURSE AND DISTANCE TO ADJACENT CORNERS IF DETERMINED IN THIS SURVEY. (MAY SKETCH OR PASTE REPRODUCTION ON REVERSE SIDE.)

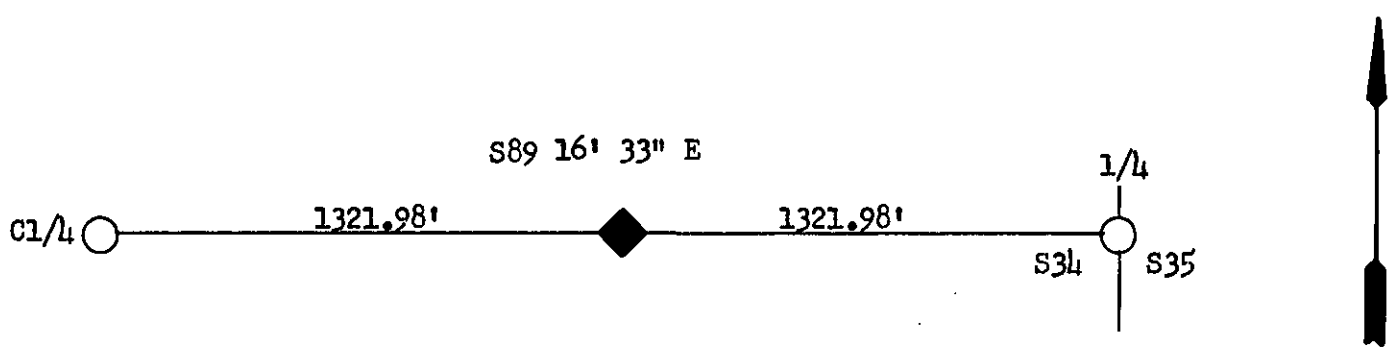

Surveyor's Seal

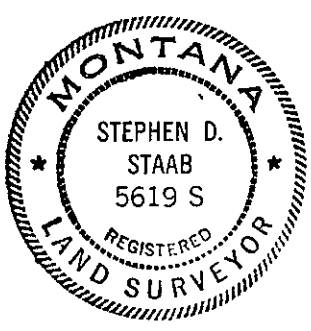

I, Kevin A Todd certify that the information shown herein is true and correct.

*Kevin A Todd*  
Signature of Ground Party Chief

I, Stephen D. Staab certify that I have carefully performed or reviewed the work done on the diagrammed corner as reported on this recordation form and approve the same.

*Stephen D Staab*  
Signature of Surveyor

DIAGRAM OF CORNER:

N. T31N R31W

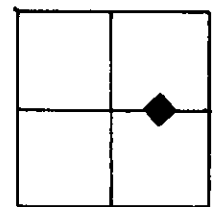

◆ = Corner recorded on the sheet

SEC. 34

5619-S  
Registration Number

Office of Clerk and Recorder, County of Lincoln

This "corner record" was filed for record on the 4th day of February 1981, was noted on the cross-index plat and is assigned page No. 995, in book No. 1

*Eleanor L. Vaughn*, by *Michele Groom*,  
County Official Deputy Mer.

Cross Index No. X-16 T. 31N R. 31W