

CERTIFIED CORNER RECORDATION

Corner **NORTH REFERENCE MONUMENT NE. COR. TRACT A** Sec. **34** T. **31N** R. **31W** P.M., **Lincoln** County **MT**

- I. No previous record
- II. No evidence found.
- III. At the calculated position determined by survey, set a P.K. nail in the highway surface for the NE. cor. of Tract A, from which:

A 3/4 in. diam., 36 in. long aluminum rod, set 34 ins. in the ground, bears NORTH, 56.0 ft. dist., with a 3 1/2 in. diam. aluminum cap marked as shown below.

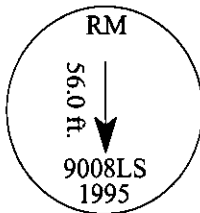

The monument is set along the North-South section line between Sec. 34 and Sec. 35, for the North reference monument to the NE. Cor. of Tract A, as shown on Certificate of Survey No. 2299, on file at the Lincoln County Courthouse.

No bearing trees.

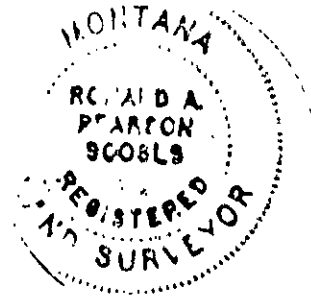

Magnetic Declination: 20° East.

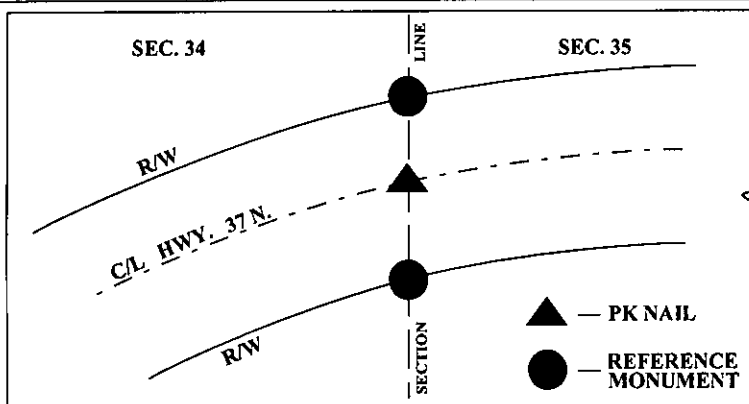

SKETCH OF CORNER

CERTIFICATION

I, Thomas M. Hommel
certify the information shown herein is true and correct.

Thomas M. Hommel
Signature Ground Party Chief

I, Ronald A. Pearson
certify that this Corner Record correctly represents work performed by me or under my direction in compliance with the "Corner Recordation Act" (70-22-101, et seq., M.C.A.)

Ronald A. Pearson
Signature of Surveyor & Seal

Date: 1/31/96
 Reg. No.: 9008LS
 Employer: U.S. FOREST SERVICE

Office of Clerk and Recorder, County of LINCOLN. This "corner record" was filed for record on AUG 21, 1997 was noted on the cross-index plat and is assigned page No. 9915, in book No. _____ CORAL M. CUMMINGS *By DEB*
County Official

