

CERTIFIED CORNER RECORDATION

Corner C N NW 1/64 Sec. 24 T. 31N R. 31W P.M., MT Lincoln County

- I. 1978 Corner Recordation filed in Lincoln County Courthouse by Stanley J. Skousen #2532-S: No record found. No evidence found. Set a 2 1/2 in. diam., 30 ins. long, alum. pipe with cap, 24 ins. in the ground.

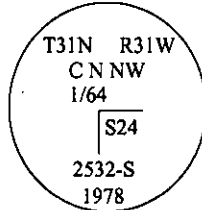

Established two bearing trees:

A fir, 12 ins. diam., bears N61°E, 37.6 ft. dist., mkd. "CNNW 1/64 S24 BT".

A fir, 10 ins. diam., bears S87°W, 7.2 ft. dist., mkd. "CNNW 1/64 S24 BT".

Raised a mound of rock around monument.

Refer to Cert. of Survey #727, subdivisions of Sec. 24, T31N R31W, as recorded in Lincoln County Courthouse, Libby, Montana.

- II. Found a 2 1/2 in. diam. alum. pipe, 6 in. above ground, firmly set, with a 3 1/4 in. alum. cap, in a collar of stone, mkd as shown.

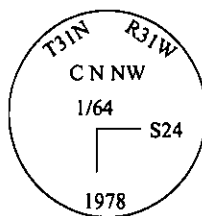

from which:

A fir stump, 14 ins. diam., bears N61°E, 37.6 ft. dist., "T" visible.

A fir, 13 ins. diam., bears S87°W, 6.6 ft. dist., mkd. with visible scribing.

2 steel guard posts, one is 1.4 ft. S., and one is 1.4 ft. W. of corner.

- III. Established one new bearing tree:

A fir, 10 ins. diam., bears N18°E, 38.5 ft. dist., mkd. "C N NW 1/64 S24 BT".

Painted red bands around the bearing trees and attached Land Survey Monument and Bearing Tree signs.
Magnetic Declination: 20° East

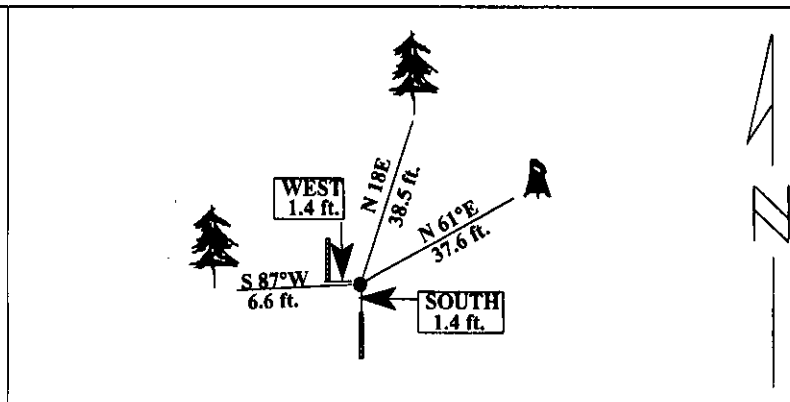

SKETCH OF CORNER

CERTIFICATION

I, Rex O. Rice
certify the information shown herein is true and correct.
Rex O. Rice
Signature Ground Party Chief

I, Alvah F. Hughes
certify that this Corner Record correctly represents work performed by me or under my direction in compliance with the "Corner Recordation Act" (50-22-101, et seq., M.C.A.)
Alvah F. Hughes
Signature of Surveyor & Seal
Date: 01/30/96
Reg. No.: 7322LS
Employer: U.S. FOREST SERVICE

MONTANA
ALVAH F. HUGHES
7322LS
REGISTERED
PROFESSIONAL LAND SURVEYOR

Office of Clerk and Recorder, County of LINCOLN. This "corner record" was filed for record on JULY 29, 1997 was noted on the cross-index plat and is assigned page No. 9760 in book No. CORAL M. CUMMINGS

County Official

By RUB

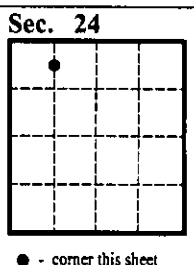

• - corner this sheet

Cross Index No. N.5-22 T. 31N R. 31W P.M.

Adopted July 1, 1981, Montana Board of Professional Engineers & Land Surveyors