

CERTIFIED CORNER RECORDATION

Corner SE Sec. Corner Sec. 8 T. 31N R. 31W P.M, MT Lincoln County

I. 1901 G.L.O. original record: Set a quartz stone and four bearing trees.

1963 B.L.M. remonumentation record by Gerald F. Pittman: The corner of secs. 8, 9, 16 and 17, monumented with a stone, 16x8x8 ins., firmly set and mkd. with 4 grooves on the E. and S. faces. Discovered remains of all four orig. bearing trees. At the corner point, set an iron post, 30 ins. long, 2 1/2 ins. diam., 26 ins. in the ground, with brass cap marked:

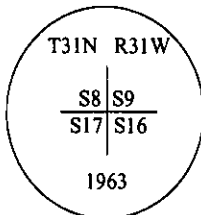

Established 4 new bearing trees.

1986 Certified Corner Recordation filed in the Lincoln County Courthouse by Thomas C. Hill: Found a BLM cap witnessed by four B.L.M. bearing trees and the remains of four orig. bearing trees. Set a guard post with "Survey Marker" decal attached, 2 ft. West from corner.

II. Found a B.L.M. brass cap, 2 in. above ground, firmly set, mkd. as shown above.

from which:

- A rotten stump, bears N52°E, 59.8 ft. dist., with visible scribing. (G.L.O.)
- A fallen pine, 9 ins. diam., bears N75°E, 22.1 ft. dist., with visible scribing. (B.L.M.)
- A stump, 29 ins. diam., bears S74°E, 41.6 ft. distant. (G.L.O.)
- A fallen stump, bears S29°E, 13.4 ft. dist., with visible scribing. (B.L.M.)
- A stumphole and remains, bears S16°W, 41.8 ft. dist., with visible scribing. (G.L.O.)
- A pine, 14 ins. diam., bears S74°W, 41.9 ft. dist., with a healed face. (B.L.M. rec. S73°W)
- A pine snag, 9 ins. diam., bears N40°W, 10.5 ft. dist., with a healed face. (B.L.M.)
- A stump, 17 ins. diam., bears N8°W, 29.8 ft. dist., with visible scribing. (G.L.O.)

III. Established three new bearing trees:

- A fir, 23 ins. diam., bears N60°E, 31.7 ft. dist., mkd. "T31N R31W S9 BT".
- A pine, 12 ins. diam., bears S39°E, 50.6 ft. dist., mkd. "T31N R31W S16 BT".
- A fir, 10 ins. diam., bears N41°W, 15.9 ft. dist., mkd. "T31N R31W S8 BT".

Painted red bands around the bearing trees and attached Land Survey Monument and Bearing Tree signs.
Magnetic Declination: 20° East

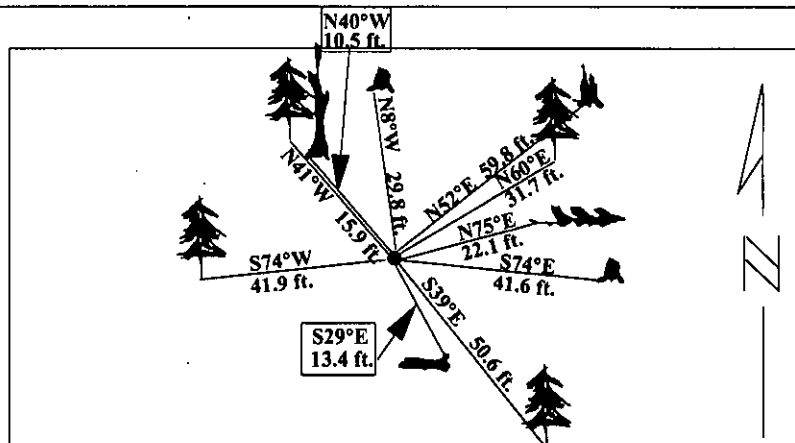

SKETCH OF CORNER

CERTIFICATION

I, Rex O. Rice
certify the information shown herein is true and correct.
Rex O. Rice
Signature Ground Party Chief
I, Alvah F. Hughes
certify that this Corner Record correctly represents work performed by me or under my direction in compliance with the "Corner Recordation Act" (7-12-1911, et seq., M.C.A.)
Alvah F. Hughes
Signature of Surveyor & Seal
Date: 1/29/95
Reg. No.: 7322LS
Employer: U.S. FOREST SERVICE

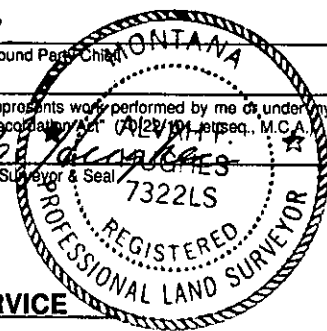

Office of Clerk and Recorder, County of LINCOLN. This "corner record" was filed for record on JULY 29, 1997 was noted on the cross-index plat and is assigned page No. 9757 in book No. _____

CORAL M. CUMMINGS

County Official *By [Signature]*

Sec. 8

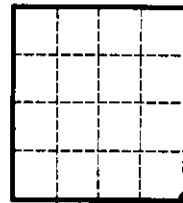

• - corner this sheet

Cross Index No. J-9 T. 31N R. 31W PMM