

CERTIFIED CORNER RECORDATION

Corner CS 1/16 Sec. 25 T. 31N R. 31W P.M., MT Lincoln County

- I. 1987 Corner Recordation by Ken E. Davis #4975-S: "I found a MDL rebar and cap which I replaced with a 3 /14 in. diam. USDA Forest Service Monument.. Set a U.S.D.A. alum. cap and pipe, 3 1/4 ins. diam. X 30 in. long, mkd. as shown."

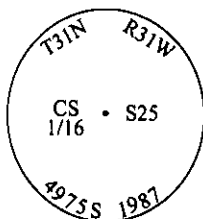

from which:

A fir, 7 ins. diam., bears N85°E, 7.0 ft. dist., mkd. "C-S 1/16 S25 BT".
A larch, 9 ins. diam., bears N45°W, 3.7 ft. dist., mkd. "C-S 1/16 S25 BT".

Set a alum. post, 2.0 ft. SE of monument. Erected a small pile of stone alongside monument.

- II. Found a 3/4 in. diam. alum. rod, 3 ins. above ground, firmly set, with a 3 1/4 in. alum. cap mkd. as shown above, from which:

A fir, 10 ins. diam., bears N85°E, 7.0 ft. dist., mkd. with visible scribing.
A larch snag, 9 ins. diam., bears N45°W, 3.7 ft. dist., mkd. with visible scribing.

- III. Established one new bearing tree:

A fir, 10 ins. diam., bears N20°W, 6.0 ft. dist., scribed "CS 1/16 S25 BT".

Painted red bands around the bearing trees and attached Land Survey Monument and Bearing Tree signs.

Magnetic Declination: 20° East

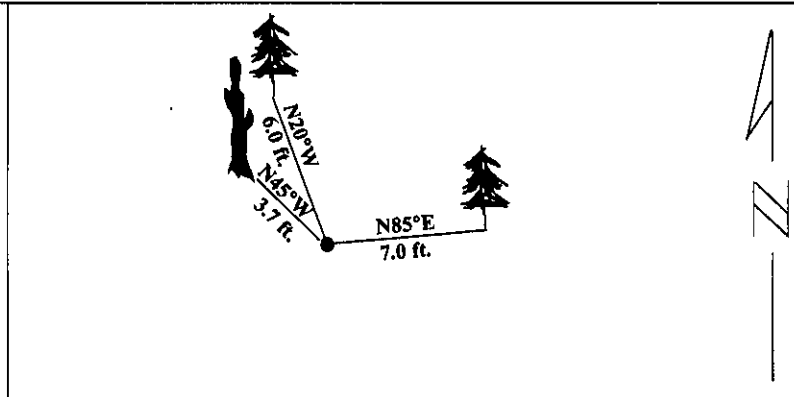

SKETCH OF CORNER

CERTIFICATION

I, **Rex O. Rice**
certify the information shown herein is true and correct.

Rex O. Rice
Signature Ground Party Chief

I, **Alvah F. Hughes**
certify that this Corner Record correctly represents work performed by me, or under my direction in compliance with the "Corner Recordation Act" (70-22-101, et seq., M.C.A.)

Alvah F. Hughes
Signature of Surveyor & Seal

Date: 01/25/96

Reg. No.: 7322LS

Employer: U.S. FOREST SERVICE

Sec. 25

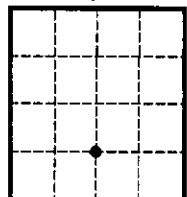

• - corner this sheet

Office of Clerk and Recorder, County of **LINCOLN** This "corner record" was filed for record on **JULY 29, 1997** was noted on the cross-index plat and is assigned page No. **9727** in book No. _____

CORAL M. CUMMINGS

County Official

By OLB

Cross Index No. U-23 T. 31N R. 31W PMM