

## CERTIFIED CORNER RECORDATION

Corner SE-SE-SW 1/256 Sec. 25 T. 31N R. 31W P.M., MT Lincoln County

I. 1987 Corner Recordation by Ken E. Davis #4975-S: "I found a MDL rebar and cap which I replaced with a 3/4 in. diam. USDA Forest Service Monument.. Set a U.S.D.A. alum. cap and pipe, 3 1/4 ins. diam. X 30 in. long, mkd. as shown."

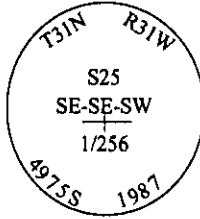

from which:

- A fir, 4 ins. diam., bears N65°E, 10.2 ft. dist., mkd. "X BT".
- A pine, 6 ins. diam., bears N25°W, 26.4 ft. dist., mkd. "X BT".

Set a alum. post, 1.0 ft. N of monument.

II. Found a 3 1/4 in. alum. cap, flush with the ground, firmly set and mkd. as shown above, from which:

- A fir, 6 ins. diam., bears N65°E, 10.2 ft. dist., mkd. with visible scribing.
- A fallen pine snag, 8 ins. diam., bears N25°W, 26.4 ft. dist., mkd. with visible scribing.

III. Established one new bearing tree:

- A fir, 8 ins. diam., bears N49°W, 23.8 ft. dist., scribed "SE SE SW 1/256 S25 BT".

Painted red bands around the bearing trees and attached Land Survey Monument and Bearing Tree signs.

Magnetic Declination: 20° East

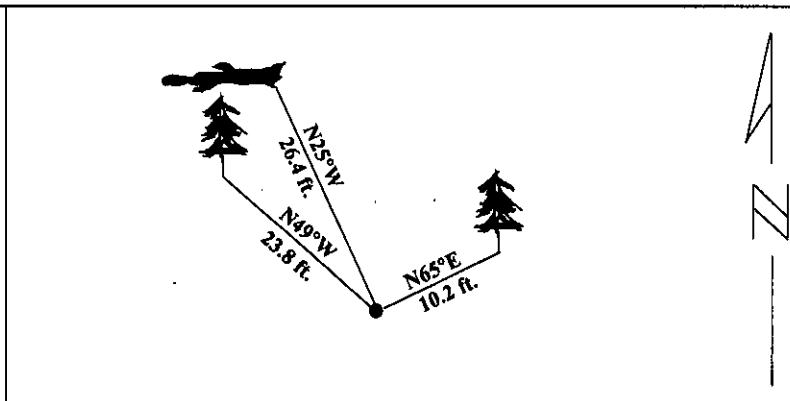

**SKETCH OF CORNER**

CERTIFICATION
I, <u>Rex O. Rice</u> certify the information shown herein is true and correct.
<u>Rex O. Rice</u> Signature Ground Party Chief
I, <u>Alvah F. Hughes</u> certify that this Corner Record correctly represents work performed by me or under my direction in compliance with the "Corner Recordation Act" (70-22-101, et seq., M.C.A.)
<u>Alvah F. Hughes</u> Signature of Surveyor & Seal
Date: <u>01/25/96</u>
Reg. No.: <u>7322LS</u>
Employer: <u>U.S. FOREST SERVICE</u>

Office of Clerk and Recorder, County of LINCOLN. This "corner record" was filed for record on JULY 29, 1997 was noted on the cross-index plat and is assigned page No. 9725 in book No. \_\_\_\_\_

**CORAL M. CUMMINGS**

County Official

*By OLB*

Sec. 25

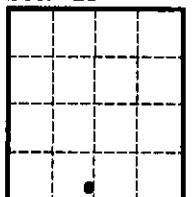

• - corner this sheet