

CERTIFIED CORNER RECORDATION

Corner SE Sec. Corner Sec. 21 T. 31N R. 31W P.M, MT Lincoln County

I. 1893 G.L.O. original record by Daniel P. Mumbrue: Set a post and four bearing trees.

1963 B.L.M. remonumentation record by G. F. Pittman, R. L. Larimer, and H. W. Grusing: The corner of secs. 21, 22, 27 and 28, as determined by the remains of the original bearing trees. At the corner point, set an iron post, 30 ins. long, 2 1/2 ins. diam., 26 ins. in the ground, with brass cap marked:

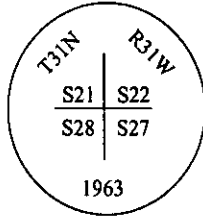

The remains of the original bearing trees:

- A stump, 16 ins. diam., bears N79°E, 28 lks. dist., mkd. "T31N R31W S22 BT". (Record N77 1/4°E)
- A stump, 12 ins. diam., bears S46 3/4°E, 16 lks. dist., with illegible marks. (Record S53°E)
- A stump, 36 ins. diam., bears S20°W, 57 lks. dist., with marks "31N 1W S28 BT" visible.
- A stump, 24 ins. diam., bears N28 1/2°W, 65 lks. dist., with illegible marks. (Record N26 1/4°W)

Established 3 new bearing trees:

- A fir, 8 ins. diam., bears N22°E, 49 lks. dist., mkd "T31N R31W S22 BT".
- A fir, 14 ins. diam., bears S2°W, 29 lks. dist., mkd "T31N R31W S28 BT".
- A pine, 4 ins. diam., bears N42 1/4°W, 15 lks. dist., mkd. "X BT".

II. Found a B.L.M. brass cap, 2 ins. above ground, mkd. as shown above, from which:

- A fir, 14 ins. diam., bears N22°E, 32.3 ft. (49 lks.) dist., with healed face. (B.L.M.)
- A stump, bears N77°E, 18.5 ft. (28 lks.) dist., with visible scribing. (G.L.O.)
- A stump, bears S53°E, 10.6 ft. (16 lks.) dist., with visible scribing. (G.L.O.)
- A fir, 23 ins. diam., bears S2°W, 85.1 ft. (129 lks.) dist., with healed face. (B.L.M. record 29 lks.)
- A pine, 9 ins. diam., bears N42°W, 9.9 ft. (15 lks.) dist., with healed face. (B.L.M.)
- A stump, bears N26°W, 42.9 ft. (65 lks.) dist., with chop marks. (G.L.O.)

III. Established one new bearing tree:

- A pine, 7 ins. diam., bears S20°E, 8.6 ft dist., mkd. "T31N R31W S27 BT".

Painted red bands around the bearing trees and attached Land Survey Monument and Bearing Tree signs.

Set a steel guard post North, 3.0 ft. from corner, with Land Survey Monument and Property Boundary decals.

Magnetic Declination: 20° East

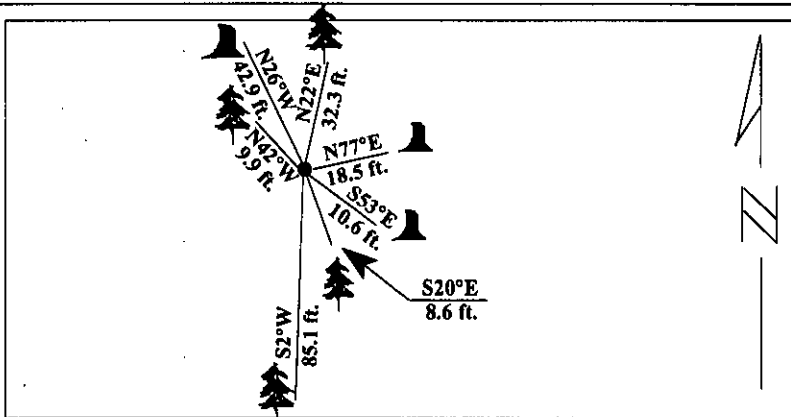

SKETCH OF CORNER

CERTIFICATION

I. **Rex O. Rice**

certify the information shown herein is true and correct.

Rex O. Rice

Signature Ground Party Chief

I. **Alvah F. Hughes**

certify that this Corner Record correctly represents work performed by me or under my direction in compliance with the Corner Recordation Act (70-22-101, et seq., M.C.A.)

Alvah F. Hughes

Signature of Surveyor & Seal

Date: **1/11/96**

Reg. No.: **7322LS**

Employer: **U.S. FOREST SERVICE**

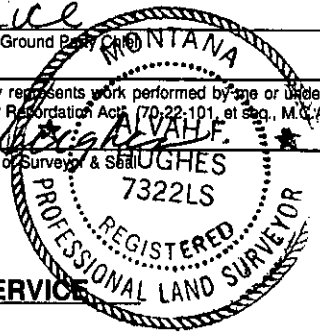

Office of Clerk and Recorder, County of **LINCOLN** This "corner record" was filed for record on **JULY 29, 1997** was noted on the cross-index plat and is assigned page No. **9718** in book No. **CORAL M. COMMINGS**

County Official *By D.B.*

Sec. 21

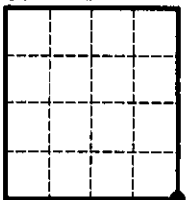

• - corner this sheet

Cross Index No.

R-13

T.

31N

R.

31W

PM