

CERTIFIED CORNER RECORDATION

Corner 1/4 Sec. 28 / 33 T. 31N R. 31W P.M., MT Lincoln County

I. 1893 original G.L.O. record by Daniel P. Munbubroe: Set post and marked two bearing trees.

1962 B.L.M. Remonumentation record by G. F. Pittman, R. L. Larimer and H. W. Grusing: The 1/4 cor. of secs. 28 and 33, monumented with the decayed remains of a wooden post, firmly set in the ground, and witnessed by the remains of the original bearing trees.

At the corner point:

Set an iron post, 30 ins. long, 2 1/2 ins. diam., 27 ins. in the ground, with brass cap mkd:

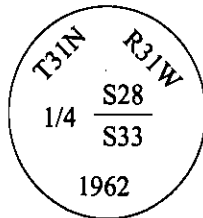

from which:

The remains of the original bearing trees:

A stump, bears S56 1/2°W, 32 lks. dist.

A stump, 20 ins. diam., bears N7°W, 50 lks. dist., mkd. with an overgrown blaze.

Established 2 new bearing trees:

A pine, 15 ins. diam., bears S36°E, 54 lks. dist., mkd. "1/4 S 33 BT".

A pine, 19 ins. diam., bears N35°W, 73 lks. dist., mkd. "1/4 S28 BT".

Buried the remains of the original wooden post alongside, and raised a flat mound of stone, 3 ft. diam., around the iron post.

II. Found a B.L.M. brass cap, firmly set, 28 ins. in the ground, marked as shown above:

from which:

A pine, ins. diam., bears S36°E, 36.2 ft. (55 lks.) dist., with visible scribing. (B.L.M. rec. 54 lks.)

A pine, 22 ins. diam., bears N35°W, 48.1 ft. (73 lks.) dist., with visible scribing. (B.L.M.)

A rotten stump, bears N7°W, 33.0 ft. (50 lks.) dist. (G.L.O.)

III. Painted bearing trees and attached Land Survey Monument and Bearing Tree signs.

Magnetic Declination: 20° East.

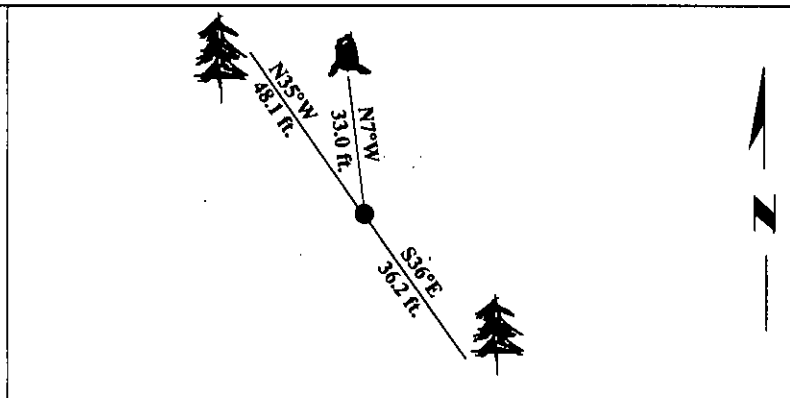

SKETCH OF CORNER

CERTIFICATION	
I. <u>Rex O. Rice</u> certify the information shown herein is true and correct.	
<u>Rex O. Rice</u>	
II. <u>Alvah F. Hughes</u> certify that this Corner Record correctly represents work performed by me or under my direction in compliance with the "Corner Recordation Act" (70-22-101, et seq., M.C.A.)	
<u>Alvah F. Hughes</u> Signature of Surveyor & Seal	
Date: <u>1/11/96</u>	
Reg. No.: <u>7322LS</u>	
Employer: <u>U.S. FOREST SERVICE</u>	

Office of Clerk and Recorder, County of LINCOLN. This "corner record" was filed for record on JULY 29, 1997 was noted on the cross-index plat and is assigned page No. 9717 in book No. _____

CORAL M. CUMMINGS

County Official

