

CERTIFIED CORNER RECORDATION

Corner S-S 1/64 Sec. 21 & 22 T. 31 N R. 31 W P.M., MT Lincoln County

- I. No previous history.
- II. No evidence found.
- III. At the position determined by survey, set a 30 in. long, 3/4 in. diam. alum. rod, 29 ins. in the ground, with a 3 1/4 in. diam. alum. cap mkd. as shown:

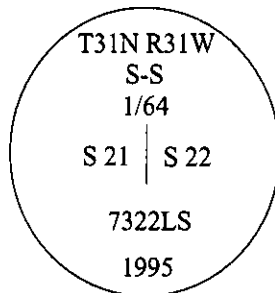

from which:

- A fir, 11 ins. diam., bears N 51°E, 136.9 ft. dist., mkd. S S 1/64 S22 BT.
- A larch, 14 ins. diam., bears N 67°W, 173.8 ft. dist., mkd. S S 1/64 S22 BT.

Painted bearing trees and attached Land Survey Monument and Bearing Tree signs.

Set a 6 ft. steel guard post with Land Survey Monument and Property Boundary decals, West, 3.0 ft. dist. from the corner.

Magnetic Declination: 20° East.

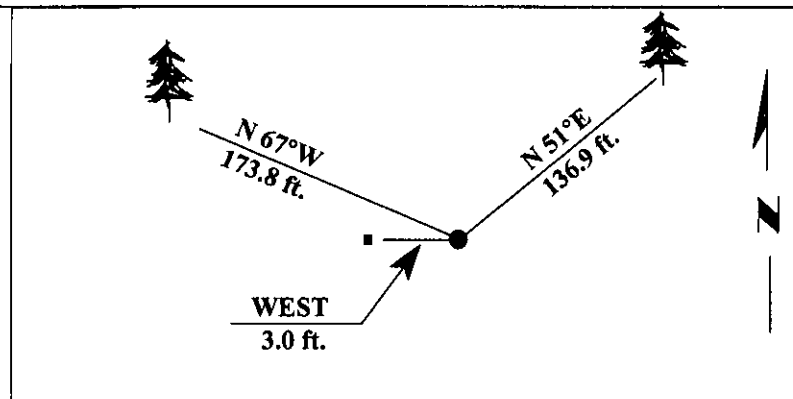

SKETCH OF CORNER

CERTIFICATION	
I, <u>Mark Federman</u>	
certify the information shown herein is true and correct.	
<i>Mark Federman</i>	
II, <u>Alvah F. Hughes</u>	
certify that this Corner Record correctly represents work performed by me or under my direction in compliance with the "Corner Recordation Act" (70-22-101, et seq., M.C.A.)	
<i>Alvah F. Hughes</i>	
Date: <u>1/3/97</u>	Signature of Surveyor & Seal
Reg. No.: <u>7322LS</u>	
Employer: <u>U.S. FOREST SERVICE</u>	

Office of Clerk and Recorder, County of LINCOLN. This "corner record" was filed for record on FEB 3, 1997 was noted on the cross-index plat and is assigned page No. 9162, in book No. CORAL M. CUMMINGS *R. J. B.*

County Official

Sec. 21

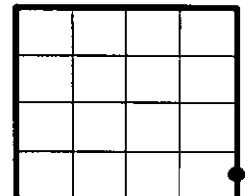

• - corner this sheet