

CERTIFIED CORNER RECORDATION

Corner 1/4 Sec. 33 & 34 T. 31N R. 31W P.M., MT Lincoln County

I. 1893 G.L.O. Original Record by Daniel P. Mumbrue et. al.: Set a wooden post, 3 ft. long, 3 ins. square, 24 ins. in the ground, for 1/4 Sec. Cor., mkd. "1/4 S" on the W. face. Established two bearing trees.

1964 B.L.M. Remonumentation Record by Gerald F. Pitman et. al.: The 1/4 sec. cor. of secs. 33 & 34, monumented with a disintegrated wooden post, firmly set in the ground, and witnessed by the remains of the original bearing trees. At the corner point, set an iron post, 30 ins. long, 2 1/2 ins. diam., 27 ins. in the ground, with the brass cap mkd. as shown:

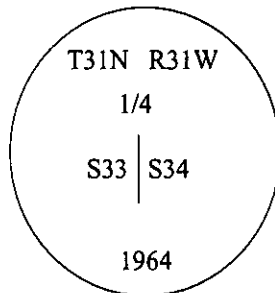

Established two new bearing trees:

A pine, 10 ins. diam., bears S80°E, 60 lks. dist., mkd. "1/4 S34 BT".

A pine, 10 ins. diam., bears N69°W, 64 lks. dist., mkd. "1/4 S33 BT".

Bury the remains of the original wooden post alongside of the iron post.

II Found a 3 1/4 in. diam. B.L.M. brass cap, firmly set, flush with the ground, mkd. as shown above.
from which:

A pine, 20 ins. diam., bears S80°E, 39.6 ft. (60 lks.) dist., mkd. with a healed face.

III Established one new bearing tree:

A pine, 11 ins. diam., bears S30°W, 63.1 ft. dist., mkd. "1/4 S33 BT".

Set a 6 ft. steel guard post, South, 4.0 ft., with Land Survey Monument and Property Boundary decals.

Painted bearing trees and attached Land Survey Monument and Bearing Tree signs.

Magnetic Declination: 20° East.

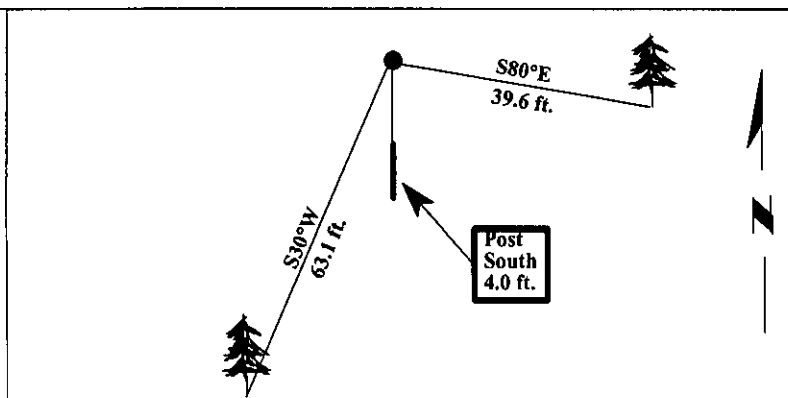

SKETCH OF CORNER

CERTIFICATION

I, Thomas Hommel
certify the information shown herein is true and correct.

I, Ronald A. Pearson
certify that this Corner Record correctly represents work performed by me or under my direction in compliance with the "Corner Recordation Act" (70-22-101, et seq., M.C.A.)

Signature of Surveyor & Seal

Date: 12/30/96

Reg. No.: 9008LS

Employer: U.S. FOREST SERVICE

Sec. 34

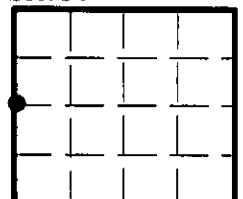

• - corner this sheet

Office of Clerk and Recorder, County of LINCOLN. This "corner record" was filed for
record on FEB 3, 1997 was noted on the cross-index plat and is assigned page No. 9111
in book No. _____

CORAL M. CUMMINGS
County Official