

CERTIFIED CORNER RECORDATION

Corner N 1/16 Sec. 33 & 34 T. 31N R. 31W P.M., MT Lincoln County

- I. 1970 Certified Land Corner Recordation Book 1, Page 206, By J.W.N. No. 354S: Set by survey, an orange T-stake, with a 2 in. diam. cap.
- II. Found a orange plastic T-stake, with a 2 in. diam. orange cap, no visible markings on cap.
from which:

A pine, 18 ins. diam., bears S42°E, 10.15 ft. dist., mkd. with visible scribe
A pine, 16 ins. diam., bears S77°W, 15.58 ft. dist., mkd. with a healed face.

Found a steel guard post, North, 1 ft. of corner, 14 ins. above the ground.
- III. At the position determined by survey, accepted the found monument and set a 30 in. long, 2 1/2 in. diam. aluminum pipe, with a 3 1/4 in. diam. aluminum cap, firmly set, 2 ins. above the ground, mkd. as shown:

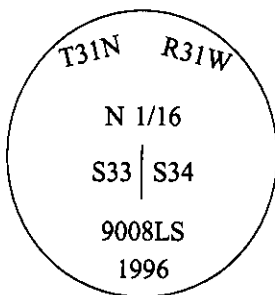

Put the T-stake inside the pipe, removed the found steel guard post.

Set a 6 ft. steel guard post, West, 3.0 ft., with Land Survey Monument and Property Boundary decals.
A powerpole, Northwest, 40 ft. from corner.

Painted bearing trees and attached Land Survey Monument and Bearing Tree signs.

Magnetic Declination: 20° East.

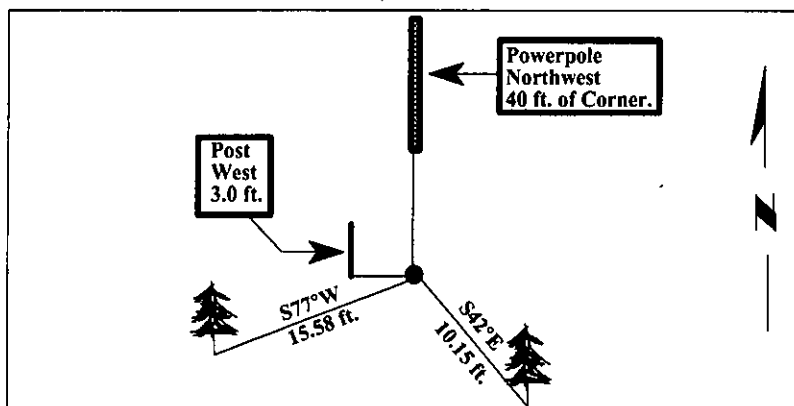

SKETCH OF CORNER

I, Thomas Hommel

certify the information shown herein is true and correct.

I, Ronald A. Pearson

certify that this Corner Record correctly represents work performed by me or under my direction in compliance with the "Corner Recordation Act" (70-22-101, et seq., M.C.A.)

Signature of Surveyor & Seal

Date: 12/30/96

Reg. No.: 9008LS

Employer: U.S. FOREST SERVICE

Office of Clerk and Recorder, County of LINCOLN. This "corner record" was filed for record on FEB 3, 1997 and was noted on the cross-index plat and is assigned page No. 9097, in book No. _____.

CORAL M. CUMMINGS

County Official

Sec. 33



● - corner this sheet

Cross index No. W-13 T. 31N R. 31W P.M., MT