

CERTIFIED LAND CORNER RECORDATION

(REFERENCE FSM 7153.53)

DESCRIPTION OF CORNER EVIDENCE FOUND, AND ORIGINAL RECORD (IF KNOWN)

Found 2½" X 30" iron post 26" in the ground with brass cap marked. From which

A fir 13" dia., bears S57½°W 52 lks. dist., marked with an overgrown blaze.

A fir 5" dia., (now 10") bears S54°E, 15 links dist., marked ¼S24 BT.

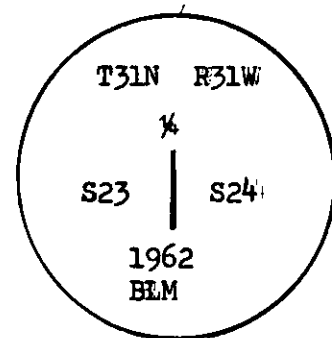

DESCRIPTION OF MONUMENT AND ACCESSORIES ESTABLISHED TO PERPETUATE THE ORIGINAL LOCATION OF THIS CORNER:

Date of work: 1978

Corner is in good condition as described. I hang ribbon in area and on BT's to perpetuate corner.

Refer to Certificate of Survey, subdivision of section 24 T31N R31W, as recorded in Lincoln County Courthouse, Libby, Montana.

SKETCH, WITH COURSE AND DISTANCE TO ADJACENT CORNERS IF DETERMINED IN THIS SURVEY. (MAY SKETCH OR PASTE REPRODUCTION ON REVERSE SIDE.)

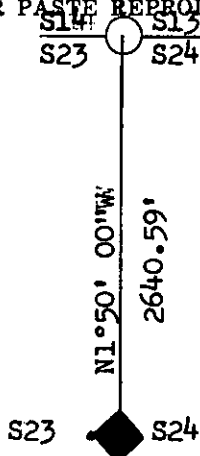

Surveyor's Seal

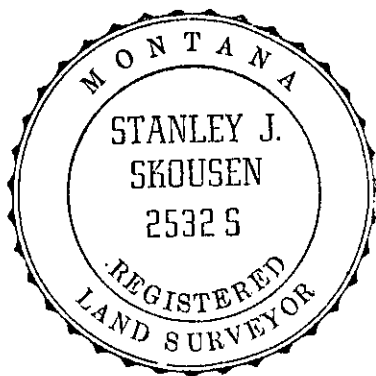

I, Stephen D. Staab OR. L.S. 1672 certify that the information shown herein is true and correct.

Stephen D. Staab
Signature of Ground Party Chief

I, Stanley J. Skousen 2532-S certify that I have carefully performed or reviewed the work done on the diagrammed corner as reported on this recordation form and approve the same.

Stanley J. Skousen
Signature of Surveyor

DIAGRAM OF CORNER:

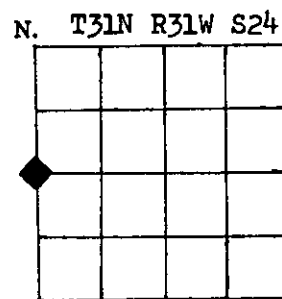

◆ = Corner recorded on the sheet

2532S

Registration Number

Office of Clerk and Recorder, County of...LINCOLN.....

This "corner record" was filed for record on the 17th day of December 1979, was noted on the cross-index plat and is assigned page No. 599, in book No. 1

Edison L. Taylor, by Scott Bell,
County Official deputy

Cross Index No. P21 T. 31N R. 31W Mer.