

CERTIFIED LAND CORNER RECORDATION
(REFERENCE FSM 7153.53)

DESCRIPTION OF CORNER EVIDENCE FOUND, AND ORIGINAL RECORD (IF KNOWN)

At the C-N-S-SE 1/256 Cor. of Section 2, T31N, R31W, Lincoln County, Montana;

No Original Record.

DESCRIPTION OF MONUMENT AND ACCESSORIES ESTABLISHED
TO PERPETUATE THE ORIGINAL LOCATION OF THIS CORNER:

Date of work: 10-18-79

Set a 2" x 30" pipe, 26" in the ground, with mound of stone. Cap marked as illustrated for exact corner position, FROM WHICH:

- A 6" fir bears N.77°E., 66.11 feet
- A 6" pine bears S.04°E., 66.3 feet

Note: Corner falls in South track of old skid road.

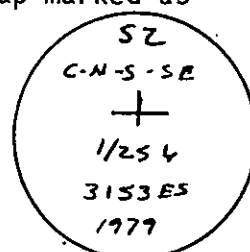

Variance Used: 17-1/2°

SKETCH, WITH COURSE AND DISTANCE TO ADJACENT CORNERS IF DETERMINED IN THIS SURVEY.
(MAY SKETCH OR PASTE REPRODUCTION ON REVERSE SIDE.)

See Certificate of Survey No. 717.

Surveyor's Seal

I, Paul S. Long
certify that the information shown herein is true and correct.

Paul S. Long
Signature of Ground Party Chief

I, THOMAS M. HANSON
certify that I have carefully performed or reviewed the work done on the diagrammed corner as reported on this recordation form and approve the same.

Thomas M. Hanson
Signature of Surveyor

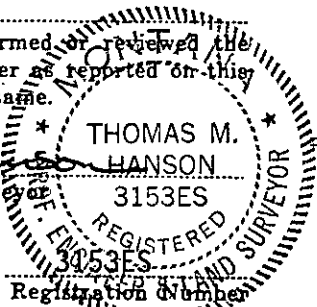
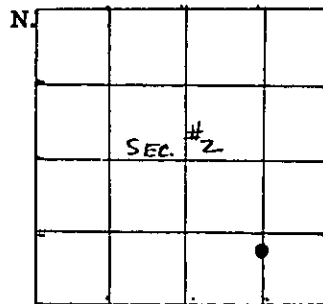

DIAGRAM OF CORNER:
T31N R31W
SECTION 2



Corner recorded on the sheet

Office of Clerk and Recorder, County of LINCOLN

This "corner record" was filed for record on the 11 day of Dec, 1979, was noted on the cross-index plat and is assigned page No. 587, in book No. 1

Edward J. ...
County Official

Cross Index No. DE-20 T. 31N R. 31W Mer.