

INSTRUCTIONS

1. Original and/or subsequent record used to evaluate the corner position.
2. Description of evidence found, note discrepancies in the record, state method of establishing lost or obliterated corners.
3. Description of monument and accessories set to perpetuate the corner position.
4. Sketch of corner, show all pertinent data which can best be shown in a sketch example, corner marking, topography ties, position of accessories, etc.
5. Certification must be signed and sealed by Land Surveyor registered in the State of Montana.
6. Fill in Cross Index & Section Diagram at bottom of sheet.

CERTIFIED CORNER RECORDATION

Corner of Secs. 12 and 13 T. 31 N. R. 31 W. P.M.M. Lincoln County

I. 1901 G.L.O. record by A. Jaqueth: Set a stone and two bearing trees for the cor. of Secs. 12 and 13.

1963 BLM remonumentation by Gerald F. Pittman et al: "The cor. of secs. 12 and 13, on the E. bdy. of the Tp., monumented with a limestone, 18x16x14 ins., firmly set and mkd. with 2 grooves on the N. and 4 grooves on the S. faces, and witnessed by the remains of the original bearing trees.

At the corner point, set an iron post, 30 ins. long, 2 1/2 ins. diam., 26 ins. in the ground, with brass cap mkd.

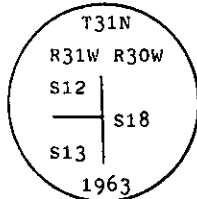

from which the remains of the original bearing trees:

- A larch, 26 ins. diam., bears S38 3/4° W, 25 lks. dist., mkd. with an overgrown blaze. (Record: S 28 1/2° W, 25 lks.)
- A dead larch, 30 ins. diam., bears N28 3/4° W, 254 lks. dist., visible marks T3 R S. (Record: N28 3/4° W, 260 lks.)

The new bearing tree:

- A larch, 8 ins. diam., bears N15 1/2° W, 21 lks. dist., mkd. T31N R31W S12 BT.

Bury the original stone alongside of the iron post."

II. Found a 2 1/2 ins. diam. pipe, 4 ins. out of the ground, with BLM brass cap mkd. as shown, from which
 A burnt larch stump, 24 ins. diam., bears S38° W, 16.5 ft. (25 lks.) dist., no visible scribing.
 A down larch, 30 ins. diam., bears N28° W, 170.0 ft. (257 lks.) dist., no visible scribing.
 A larch, 9 ins. diam., bears N13° W, 13.9 ft. (21 lks.) dist., visible scribing.

III. Established two new bearing trees

- A cedar, 12 ins. diam., bears S40° W, 36.1 ft. dist., mkd. T31N R31W S13 BT.
- A larch, 11 ins. diam., bears N42° W, 12.0 ft. dist., mkd. T31N R31W S12 BT.

Painted red bands around the bearing trees and attached Land Survey Monument and Bearing Tree signs.
 Set a 6 ft. galvanized steel guard post with Land Survey Marker and Property Boundary decals, West, 3 ft.
 Magnetic Declination: 20° East

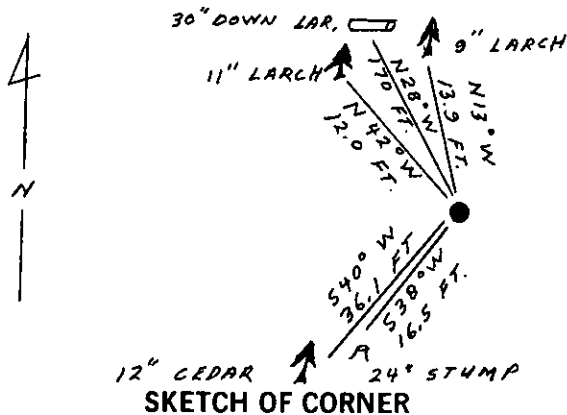
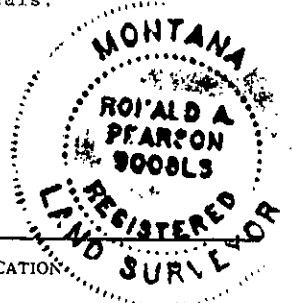

SKETCH OF CORNER

CERTIFICATION

I, Kevin A. Todd
 certify the information shown herein is true and correct.
Kevin A. Todd
 Signature Ground Party Chief

I, Ronald A. Pearson
 certify that this Corner Record correctly represents work performed by me or under my direction in compliance with the "Corner Recordation Act" (70-22-101 et seq., M.C.A.)
Ronald A. Pearson
 Signature of Surveyor & Seal

Date: 5/8/91 Reg. No. 9008 LS
 Employer: U.S. FOREST SERVICE

Office of Clerk and Recorder, County of Lincoln. This "corner record" was filed for record on Aug 13, 1991 was noted on the cross-index plat and is assigned page No. 4559, in book No. _____, in Coal M. Cummings by Bill Buckley County Official

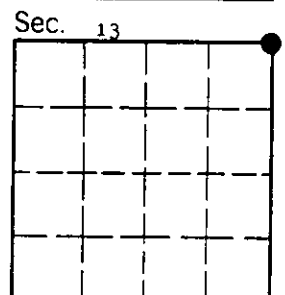

Cross Index No. J-25 T. 31 N R. 31 W P.M.M.

• - corner this sheet