

INSTRUCTIONS

1. Original and/or subsequent record used to evaluate the corner position.
2. Description of evidence found, note discrepancies in the record, state method of establishing lost or obliterated corners.
3. Description of monument and accessories set to perpetuate the corner position.
4. Sketch of corner, show all pertinent data which can best be shown in a sketch example, corner marking, topography ties, position of accessories, etc.
5. Certification must be signed and sealed by Land Surveyor registered in the State of Montana.
6. Fill in Cross Index & Section Diagram at bottom of sheet.

CERTIFIED CORNER RECORDATION

Corner 1/4 Cor. of Secs. 3 & 4 T. 31 N. R. 31 W. P.M.M. Lincoln County

- I. 1901, G.L.O. original record by Abram L. Jaqueth: Set a stone monument, marked a tamarack and pine for bearing trees.

1963, B.L.M. remonumentation record by Gerald F. Pittman et al: "The 1/4 sec. cor. of secs. 3 and 4, monumented with a argillite stone, 18x16x8 ins., firmly set and mkd. 1/4 on the W. face, and witnessed by the remains of the original bearing trees.

At the corner point.

Set an iron post, 30 ins. long, 2 1/2 ins. diam., 26 ins. in the ground, with brass cap mkd.

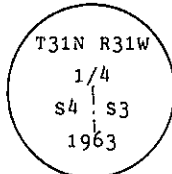

from which

The remains of the original bearing trees:

- A stump, 22 ins. diam., bears S15° E, 25 lks. dist., visible marks S3. (Record)
A stump, 30 ins. diam., bears N55° W, 62 lks. dist., visible marks BT. (Record: N55° W, 62 lks. dist., visible marks BT. (Record: N57° W, 62 lks.))

The new bearing trees:

- A pine, 6 ins. diam., bears N64° E, 39 lks. dist., mkd. 1/4 S3 BT.
A pine, 6 ins. diam., bears N56° W, 20 lks. dist., mkd. 1/4 S4 BT.

Bury the original stone alongside of the iron post."

- II. Found, a 3 1/4 ins. diam., B.L.M. brass cap, marked as shown above, on a 2 1/2 ins. diam. iron pipe, 7 ins. out of the ground, from which

- A ponderosa pine, 12 ins. diam., bears N65° E, 26.0 ft. (39.4 lks.) dist., scribe marks overgrown. (B.L.M. record)
A saw stump, 2 ft. high by 22 ins. diam., bears S16° E, 16.5 ft. (25.0 lks.) dist., visible marks S3. (G.L.O. record)
A saw stump, 2 ft. high by 24 ins. diam., bears N54° W, 41.9 ft. (63.5 lks.) dist., visible mark, part of 4. (G.L.O. record)
A ponderosa pine, 12 ins. diam., bears N55° W, 12.9 ft. (19.5 lks.) dist., scribe marks overgrown. (B.L.M. record)

- III. Set a 6 ft. galvanized steel guard post with Land Survey Marker decal, North, 3 ft.

Painted red bands around the bearing trees and attached Land Survey Monument and Bearing Tree signs where needed.

Magnetic Declination: East, 19°

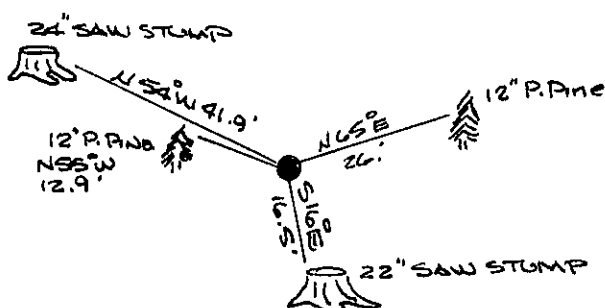

SKETCH OF CORNER

CERTIFICATION
Gary C. Crismon

I, _____
certify the information shown herein is true and correct.

Signature Ground Party Chief
Ronald A. Pearson

I, _____
certify that this Corner Record correctly represents work performed by me or under my direction in compliance with the "Corner Recordation Act" (70-22-101, et seq., M.C.A.)

7/9/90 Signature of Surveyor & Seal
9008-LS

Date: _____ Reg. No. _____

Employer: U.S. FOREST SERVICE

Office of Clerk and Recorder, County of Lincoln. This "corner record" was filed for record on Nov 8, 1990 was noted on the cross-index plat and is assigned page No. 4289 in book No. _____

Janet H. Sugil by Bill Buck
County Official

C-13

Cross Index No. _____ T. _____ R. _____ PMM

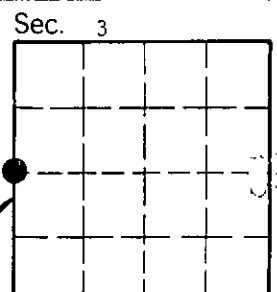

• - corner this sheet