

INSTRUCTIONS

1. Original and/or subsequent record used to evaluate the corner position.
2. Description of evidence found, note discrepancies in the record, state method of establishing lost or obliterated corners.
3. Description of monument and accessories set to perpetuate the corner position.
4. Sketch of corner, show all pertinent data which can best be shown in a sketch example, corner marking, topography ties, position of accessories, etc.
5. Certification must be signed and sealed by Land Surveyor registered in the State of Montana.
6. Fill in Cross Index & Section Diagram at bottom of sheet.

CERTIFIED CORNER RECORDATION

Corner NW Cor. Sec. 7 T. 31 N. R. 31 W. P.M.M. Lincoln County

- I. 1901 Original GLO record by Jaqueth: "Set a limestone, 20 x 14 x 6 ins., 15 ins. in the ground, for cor. of Secs. 1, 6, 7, and 12, marked with 5 notches on S. and 1 notch on N. edge." Establish 4 BT's.

1963 BLM Remonumentation by Pittman, Larimer, and Grusing: "Set an iron post, 30 ins. long, 2 1/2 ins. diam. 8 ins. in the ground, to bedrock, and in a mound of stone, 5 ft. diam., to top, with brass cap mkd.

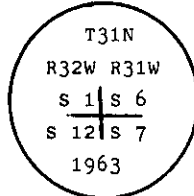

from which, the remains of the original bearing trees

A stump, 12 in. diam., bears N.61 1/2° E., 54 lks. dist., visible marks 31N R31W S6.
(Record: N.63° E., 54 lks.)

A fir, 16 ins. diam., bears S.51 3/4° E., 70 lks. dist., visible marks 31 7.
(Record: S.50° 50' E., 73 lks.)

A fir, 14 ins. diam., bears S.36 3/4° W., 16 lks. dist., with illegible scribing.
(Record: S.34° W., 16 lks.)

A fir, 15 ins. diam., bears N.1° W., 48 lks. dist., visible marks 32. (Record)

The new bearing tree:

A fir, 14 ins. diam., bears N.30 1/4° E., 55 lks. dist., mkd. T31N R31W S6 BT.

Bury the original stone alongside of the iron post.

- II. I found a 2 1/2 in. diam. iron pipe, 5 in. out of ground with a BLM brass cap. mkd as shown above, from which

The original bearing trees:

A Douglas Fir, 15 in. diam., bears N.31° E., 35.8 ft. (54 lks) dist., scribe visible.

A root crown, bears N 63° E, 37.0 ft. (56 lks), with dead down remains of log down hill from root crown (4 ft. long x 14 in. diam.). Scribe visible.

A Douglas Fir, 18 in. diam., bears S.50° E., 48.1 ft. (73 lks), scribe overgrown.

A Douglas Fir, 16 in. diam., bears S.35° W., 10.3 ft. (12 lks), scribe overgrown.

A Douglas Fir, 18 in. diam., bears N.2° E, 31.3 ft. (47 lks), scribe visible.

- III. I painted red bands around BT's and replaced BT's signs and attached land survey monument signs to BT's. I set a 6 ft. galvanized steel guard post 3 ft. east of monument, with property boundary and land survey monuments attached.

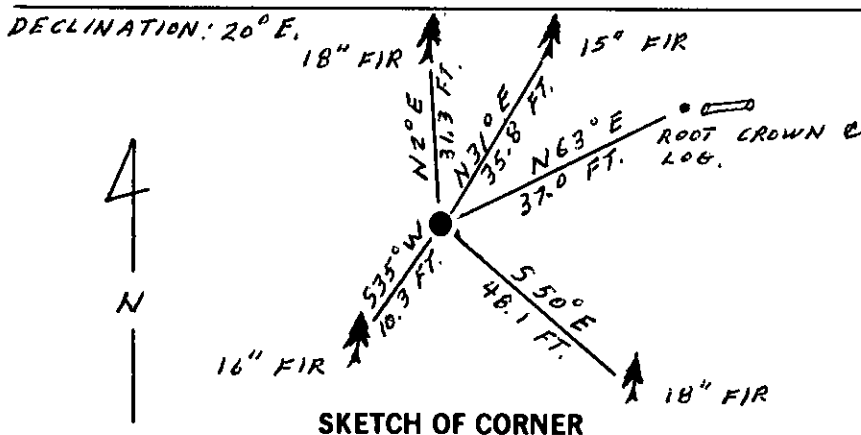

SKETCH OF CORNER

CERTIFICATION

I, Gary Crismon,
certify the information shown herein is true and correct.

Gary Crismon
Signature Ground Party Chief

I, Ronald A. Pearson
certify that this Corner Record correctly represents work performed by me or under my direction in compliance with the "Corner Recordation Act" (70-22-104, et seq., M.C.A.)

Ronald A. Pearson
Signature of Surveyor & Seal

Date: 8-14-89 Reg. No. 9008LS
U.S. FOREST SERVICE

Employer: _____

Office of Clerk and Recorder, County of Lincoln. This "corner record" was filed for record on Sept 11, 1989

was noted on the cross-index plat and is assigned page No. 4071, in book No. _____

Janet B. Sugilby
County Official

Cross Index No. E-1 T. T31 N. R. R31 W P.M.M.

Sec. 7

• - corner this sheet

I. ORIGINAL AND/OR SUBSEQUENT RECORD:

The record data helps support the reestablished corner position because it clearly shows what history the surveyor based his corner position on. In some cases, however, the record may be unknown or not pertinent. A statement to that effect should appear on the corner record.

II. DESCRIPTION OF EVIDENCE FOUND OR METHOD OF LOCATING CORNER POSITION:

If no physical evidence of the original or subsequent monuments and accessories can be found, then the method used to reestablish the lost or obliterated corner (single proportion, fence intersection, parol evidence, terrain calls, centerline of road, etc.) shall be indicated.

III. DESCRIPTION OF MONUMENTS AND ACCESSORIES SET TO PERPETUATE THE CORNER POSITION:

References or ties to other corners are optional and may be drawn on the face or back of the corner record form, or references to Certificate of Survey may be made. Separate drawings may be attached to the corner form.

If state plane coordinate values for the corner position are shown, then the control upon which they are based should be indicated.

IV. SKETCH OF CORNER:

This item will usually show how a found or set corner is marked and may also show topography or accessory monuments found or set and their relation to the corner. There is no stipulated format; the sketch could be transcribed field note entries.

V. CERTIFICATION:

The name and signature of the ground party chief is optional.

The Surveyor who performed or directed the field work which is depicted on the "Certified Corner Record" shall sign and affix his seal in the Certification.

The employer blank is optional but useful in tracking down original field note data or adjacent record if, in the future, questions arise about the corner.

vi.

The Cross Index at the bottom of the page should be completed by the Surveyor. Only the single Township Index where the corner is filed shall be completed.

The lower righthand corner is a corner location diagram and should have the pertinent section filled in at the top and a closed circle indicating the appropriate corner position in the section filled in. This is intended to be an aid in searching the "Record" once it has been filed.

