

CERTIFIED LAND CORNER RECORDATION

Cadastral Retracement of sec. cor. ^{26|25} 35|36 T31N R31W Montana Principal Mer.

DESCRIPTION OF CORNER EVIDENCE FOUND, AND ORIGINAL RECORD (IF KNOWN)

T31N R31N M.P.M. G.L.O. notes book 8942 page 61 has iron post 30" long 2 1/2" in diameter 26" in the ground with brass cap marked: T31N R31N

Found brass cap in good condition and undisturbed.

S26|S25
S35|S36
1962

Record: decayed stump bearing S73°W, 161 lks. with scribe R31W S35 BT
Found: stump still preserved

Record: Decayed stump bearing N27 1/2°W, 100 lks. with scribe not visible.
Found: Stump still preserved.

Record: 8" Pine bearing N26°E, 103 lks. with scribe T31N R31W S25 BT
Found: ~~Bearing tree alive and still growing with present diameter of 11"~~

DESCRIPTION OF MONUMENT AND ACCESSORIES ESTABLISHED TO PERPETUATE THE ORIGINAL LOCATION OF THIS CORNER:

Date of work: 3/29/74

No added Monumentation.

SKETCH, WITH COURSE AND DISTANCE TO ADJACENT CORNERS IF DETERMINED IN THIS SURVEY.
(MAY SKETCH OR PASTE REPRODUCTION ON REVERSE SIDE.)

Sketch on reverse side.

Surveyor's Seal

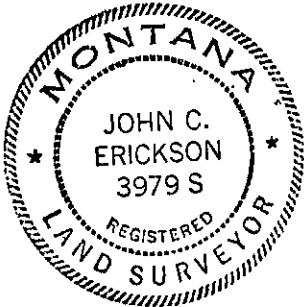

I, James R. Staples certify that the information shown herein is true and correct.

James R. Staples
Signature of Ground Party Chief

JOHN C. ERICKSON

I, _____ certify that I have carefully performed or reviewed the work done on the diagrammed corner as reported on this recordation form and approve the same.

John C. Erickson
Signature of Surveyor

3979 S
Registration Number

DIAGRAM OF CORNER:

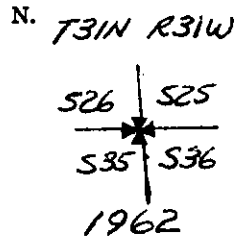

= Corner recorded on the sheet

Office of Clerk and Recorder, County of Lincoln

This "corner record" was filed for record on the 28 day of Mar 1987, was noted on the cross-index plat and is assigned page No. 4007, in book No. _____

Grant H. Seigel by Bill Bickhoff
County Official

Continued on reverse side

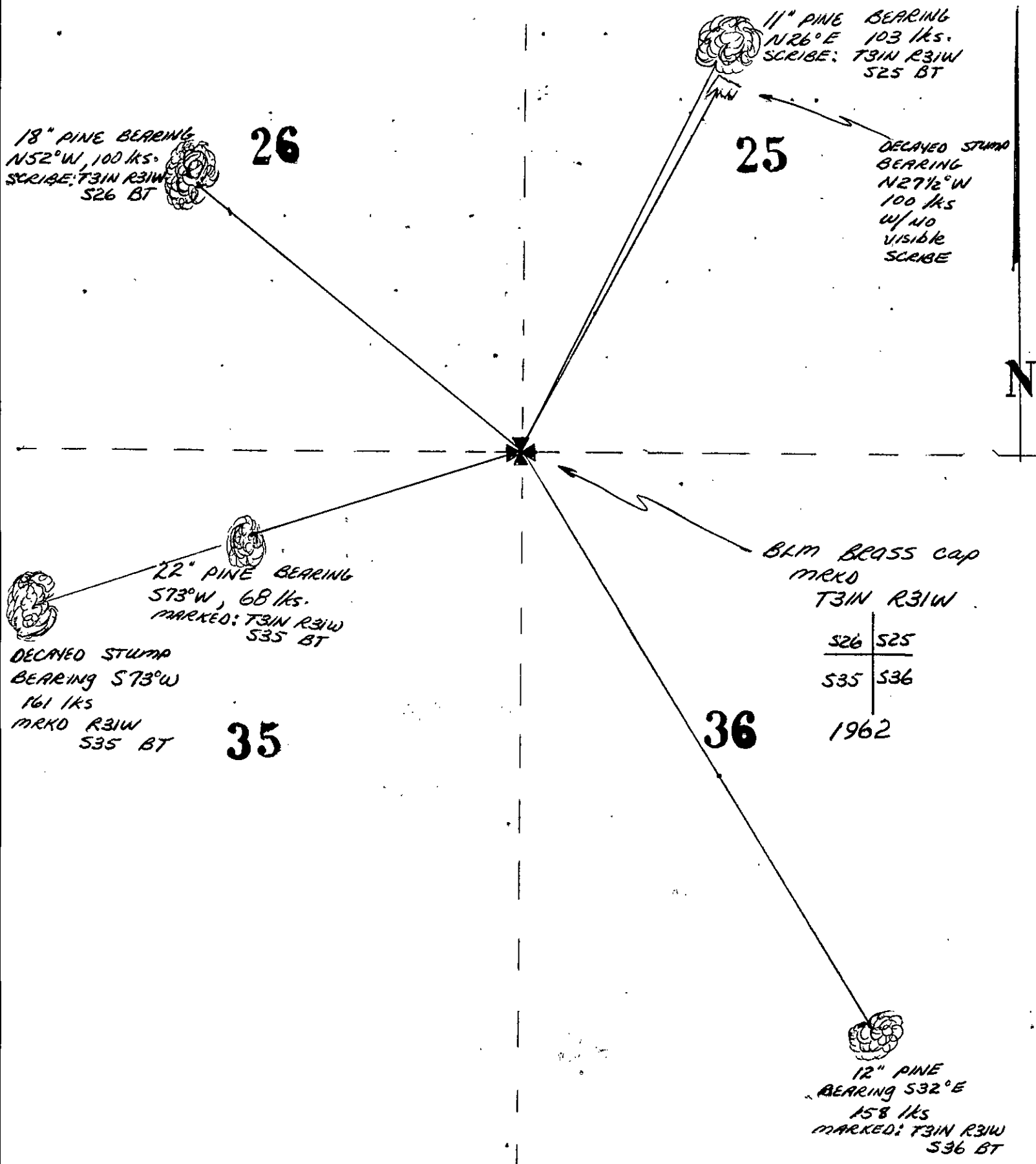

Description of evidence found cont. from page 1

- Record: 10" pine bearing S32°E, 158 lks. with scribe T31N R31N S36 BT
 Found: Bearing tree alive and still growing with present diameter of 12"
- Record: 14" pine bearing S73°W, 68 lks. with scribe of T31N R31W S35 BT
 Found: Bearing tree alive and still growing with present diameter of 22"
- RECORD: 11" Pine bearing N52°W, 100 lks. with scribe T31N R31W S26 BT
 Found: Bearing tree alive and still growing with present diameter of 18"